

Mid-Michigan Buyers Guide

SUNDAY, SEPTEMBER 23, 2018

Serving Clare, Gladwin, Gratiot, Isabella, Montcalm, & Southern Roscommon Counties





Morning Star Publishing Company powered by digitalfirst

The

AUTO GROUP OF MT. PLEASANT

Largest Inventory in Mid Michigan!
Check out our complete inventory www.theautogroup.biz

FALL Savings EVENT

 <p>2011 EQUINOX AWD \$11,995</p>	 <p>2013 TAURUS \$11,995</p>	 <p>2010 GRAND CHEROKEE \$12,600</p>	 <p>2015 200 S \$12,900</p>	 <p>2013 SUBARU OUTBACK \$13,995</p>
 <p>2014 FUSION SE \$14,900</p>	 <p>2013 JOURNEY AWD \$15,995</p>	 <p>2011 LINCOLN MKX AWD \$15,995</p>	 <p>2009 F150 FX4 \$16,900</p>	 <p>2014 TOWN & COUNTRY \$16,900</p>
 <p>2011 RANGER 4X4 \$16,900</p>	 <p>2014 HYUNDAI SANTA FE AWD \$18,600</p>	 <p>2013 AVALANCHE \$24,400</p>	 <p>2015 TRAVERSE LTZ AWD \$25,900</p>	 <p>2015 CHEROKEE TRAILHAWK \$25,900</p>
 <p>2016 DURANGO LIMITED \$26,500</p>	 <p>2012 F350 XLT \$26,995</p>	 <p>2014 F150 FX \$27,900</p>	 <p>2015 SIERRA \$27,900</p>	 <p>2013 F150 PLATINUM \$27,995</p>
 <p>2012 SIERRA 2500 HD \$29,900</p>	 <p>2015 F250 LARIAT \$29,995</p>	 <p>2014 F150 FX4 \$29,995</p>	 <p>2013 RAM LARAMIE \$29,995</p>	 <p>2014 YUKON DENALI \$30,500</p>
 <p>2014 RAM 1500 CREW CAB \$30,900</p>	 <p>2014 F150 FX4 \$30,995</p>	 <p>2016 SILVERADO LT \$31,400</p>	 <p>2015 F150 XLT \$31,995</p>	 <p>2016 SIERRA 2500 HD \$32,900</p>
 <p>2016 SILVERADO LT CREW \$32,995</p>	 <p>2016 F150 XLT \$33,995</p>	 <p>2014 RAM 2500 CREW CAB \$36,995</p>	 <p>2016 SILVERADO HIGH COUNTRY \$37,995</p>	 <p>2017 SIERRA CREW SLT \$40,900</p>
 <p>2015 YUKON DENALI \$40,900</p>	 <p>2013 RAM 2500 CUMMINGS \$41,900</p>	 <p>2015 F350 SUPERDUTY POWER STROKE \$44,595</p>	 <p>2016 SUBURBAN LTZ \$45,995</p>	 <p>2016 SIERRA 2500 HD, DURAMAX \$48,900</p>

• LIFETIME ENGINE WARRANTY • LIFETIME ENGINE WARRANTY • LIFETIME ENGINE WARRANTY • LIFETIME ENGINE WARRANTY

EVERYONE IS APPROVED!!! Regardless Of Your Credit History!
Let Our In-House Finance Experts Help Get You Into The Vehicle Of Your Dreams!

AUTO GROUP

4720 E. Pickard (M-20) • Mt. Pleasant, MI
877-772-1113 OR 989-772-1113

All prices plus tax, title, plate & doc fees.

VIEW OUR COMPLETE INVENTORY AT
www.theautogroup.biz

MIAL MEADOWS MHP
 WE HAVE 2 & 3 BEDROOM
 MOBILE HOMES FOR SALE
 OR LEASE IN ALMA
 LOT RENT \$290
 HOMES ARE GOING FAST. DON'T WAIT!!
 CALL TERESA AT **989-528-8247**
 TO SCHEDULE A TIME TO SEE YOUR NEW HOME!
 TERESA & JIM DAVIDSON
 RESIDENT MANAGERS 411 S. GROVER, #31
 ALMA, MI 48801

214 W. Fourth St. Clare
(989) 386-7200
 3816 E. Rosebush Rd. Rosebush
(989) 433-1004
 www.clareauto.com

CLARE **BUMPER TO BUMPER**
 Auto Parts Specialists

Beka BATTERIES
 Lawn and Garden Batteries from **\$29.95**
 Marine Deep Cycle Batteries from **\$79.95**
 Marine Starting Batteries from **\$59.95**

CLEAN SWEEP and HOUSEHOLD HAZARDOUS WASTE COLLECTION
ISABELLA COUNTY FAIR GROUNDS
SATURDAY - September 29, 2018
8:00 a.m. - 12:00 noon
DISPOSE OF UNWANTED:

CLEAN SWEEP
 • Pesticides
 • Herbicides
 • Mercury

HOUSEHOLD WASTE
 • Fluorescent Bulbs
 • Batteries; regular, lithium, & lead acid
 • Paint - **OIL BASED ONLY**
 • Solvents & Cleaners
 • Acids & Disinfectants
 • Unwanted/Expired Medications

****WE WILL NOT BE ACCEPTING LATEX PAINT****
 Remove the lid from the paint container and let it dry out. Latex paint is not toxic you can dispose of it in your regular garbage.
 We would like to thank the Saginaw Chippewa Indian Tribe for supporting this program and providing the district with 2% funds for the Household Hazardous Waste portion of the collection.
 For more information contact the Isabella Conservation District @ 989-772-9152 ext. 3.

Sponsored by:
 Michigan Department of Agriculture
 ISABELLA CONSERVATION DISTRICT

Look twice... Save a life!

Motorcycles are EVERYWHERE

FALL IS RIGHT AROUND THE CORNER!
We Can Help Get Your Vehicle Ready!

Front End Alignment Special
\$62.95 Most Vehicles w/Coupon Expires 12-31-18
4-WHEEL \$94.45 Most Vehicles w/Coupon MMBG Expires 12-31-18

Dexos Lube, Oil, Filter Special
 Change Oil, Change Oil Filter, Check All Fluid Levels & Lubricate Fittings
\$38.50 Up to 5 qts. - Additional oil or fluids extra
 Expires 12-31-18 MMBG

COOLING SYSTEM FLUSH \$114.45
 Most Vehicles w/Coupon Expires 12-31-18 MMBG

Automatic Transmission Service All Fluid Flush SPECIAL \$127.05
 Change All Fluids - 12 qts. Most Vehicles w/Coupon Expires 12-31-18 MMBG

Any Repair 10% OFF
 Most Vehicles w/Coupon Expires 12-31-18 Not valid with tire sale or any other coupon offer MMBG

McGUIRE **70 Years Strong!**
 www.McGuireChevrolet.com **989-386-7714**
 FIND NEW ROADS

FINAL ANNUAL ALPACA FUN DAYS
AT ISABELLA ALPACAS
 7797 Curtis Rd. Mt. Pleasant, MI
 1/2 Mile W. of Winn
SEPT 29TH & SEPT 30TH
10AM to 5PM

FREE ADMISSION!

Tractor Display Saturday @ 1:00pm

Free hot dogs, popcorn & balloons

Steve's Country Market
 989-539-3110 3170 North Clare Ave., Harrison 44 Feet of Old Fashioned Meat Counter with Good Old Fashioned Service
 Hours: Sun. - Mon. 8-8 Bridge Card & Wic Accepted Sale Dates: SEPTEMBER 24 - SEPTEMBER 30, 2018

Top Quality Meats At Rock Bottom Prices! **100% Satisfaction Guaranteed** Michigan Lottery **stevescountrymarket.com**

FRESH MEAT AND SEAFOOD ITEMS

GROUND CHUCK FAMILY PACK 5 LBS. OR MORE \$2.79 LB.	BONELESS CHICKEN BREAST \$1.69 LB.	WHOLE RIBEYE LOINS SLICED FREE! \$4.49 LB.	USDA CHOICE T BONE STEAKS \$7.99 LB.	USDA CHOICE TOP ROUND LONDON BROIL \$3.99 LB.	USDA CHOICE BONELESS ENGLISH ROAST \$3.29 LB.
FRESH GROUND ROUND \$3.69 LB.	BEEF CUBED STEAK \$3.99 LB.	COMBINATION PORK & BEEF ROAST \$2.99 LB.	BABY BACK RIBS \$3.29 LB.	BAR S HOT DOGS 1 LB. 99¢ EA.	ECKRICH FRANKS OR BOLOGNA 2/\$3.00 14 OZ.
SALMON FILLETS \$6.99 LB.	TILAPIA FILLETS \$2.99 LB.	WHOLEY BRAND RAW SHRIMP 31/40 CT. 1 LB. PKG. \$5.99 EA.	COD LOINS \$5.99 LB.		

Deli ECKRICH DELI HAM \$3.99 LB. ECKRICH HARD SALAMI \$4.49 LB. PROVOLONE CHEESE \$3.99 LB. COLBY OR COJACK CHEESE \$4.49 LB.	Fresh Produce MICHIGAN APPLES 3 LB. BAG SELECT VARIETIES \$2.00 EA. MICHIGAN ROUND WHITE POTATOES 5 LB. BAG 2/\$3.00 MICHIGAN APPLE CIDER GALLON \$4.99 EA. MICHIGAN SQUASH 49¢ LB.	Fresh Dairy And Frozen PRAIRIE FARMS ICED COFFEE 1/2 GALLON \$2.49 EA. NORTH STAR ICE CREAM CONES 6 PK. \$2.99 EA. SAVE CHEESE BY WILLIAMS 1.5 LB. \$5.99 EA. 4 QUART PAIL ICE CREAM \$5.99 EA.	Grocery OUR FAMILY SALTINE CRACKERS 16 OZ. \$1.69 EA. DORITOS 10-11 OZ. 2/\$5.00 HILLBILLY BREAD 20 OZ. 2/\$3.00 MILLER LIGHT OR COORS LIGHT 24 PK. CANS PLUS DEPOSIT \$15.99 EA. BROOK'S CHILI BEANS 15.5 OZ. 99¢ EA. RUFFLES POTATO CHIPS 9-13 OZ. 2/\$5.00 AUNT MILLIE'S JOHNSONVILLE HONEY HOT DOG OR HAMBURG BUNS 8 CT. 2/\$3.00 BUD OR BUD LIGHT 15 PK. CANS PLUS DEPOSIT \$9.99 EA.
--	--	--	---

While supplies last. Not responsible for printing errors.

BRIAN'S FRUIT & MEAT MARKET

2167 S. M-76 • West Branch (Across from Kmart)

While Supplies Last • Not responsible for printing errors
Prices good Sunday, September 23rd through Friday, September 28th, 2018
Store Hours: Sunday 8am-6pm • Mon-Sat 7am-8pm

WE ARE A PACKAGED LIQUOR DEALER

We accept all major credit cards & EBT card

BRIAN'S MEATS: 989-345-3709

LIKE US ON FACEBOOK



WWW.BRIANSFRUITANDMEATMARKET.COM

Proudly Featuring

Boar's Head
PREMIUM DELI MEATS & CHEESES

GLUTEN FREE

long before you even thought to ask

TRUST BOAR'S HEAD FOR - NO TRANS FAT
- NO ARTIFICIAL FLAVORS OR COLORS
- NO FILLERS - NO BY PRODUCTS
TRY OUR NEW BOAR'S HEAD CHICKEN SAUSAGES!!

SLICED KETTLE FRIED TURKEY BREAST \$6⁹⁹ lb.	SLICED SWISS CHEESE \$5⁹⁹ lb.	SLICED DOUBLE SMOKED HAM \$5⁹⁹ lb.	KOEGEL PICKLED BOLOGNA & RED HOTS \$10⁴⁹ ea. 2.5 lb. Jug	10 LB. SPECIALS	
BONELESS BEEF TOP SIRLOIN STEAKS \$4⁹⁹ lb.	BONELESS BEEF SIRLOIN TIP ROAST \$3⁶⁹ lb.	FRESH GROUND BEEF FROM SIRLOIN \$3⁹⁹ lb. or \$3⁶⁹ 10 lb. or more	BONELESS PORK SIRLOIN SIZZLERS \$1⁹⁹ lb.	BONELESS CENTER LOIN PORK ROASTS \$2⁴⁹ lb.	10 LB. POLLOCK FILLETS \$19⁰⁰ box
SEMI BONELESS PORK SHOULDER BUTTS \$1⁷⁹ lb.	BRIARS HOMEMADE FRESH BRATS \$3⁹⁹ lb.	BRIARS OWN BULK BREAKFAST SAUSAGE \$1⁹⁹ lb. or \$1⁷⁹ 10 lb. or more	FRESH BONELESS SKINLESS CHICKEN BREAST \$1⁷⁹ lb. or \$1⁴⁹ 10 lb. Pre-bagged or \$1³⁹ 40 Box	10 LB. COD LOINS \$48⁰⁰ box	10 LB. BONELESS SKINLESS CHICKEN BREAST \$14⁹⁰ bag
				10 LB. BULK BREAKFAST SAUSAGE \$1⁷⁹ lb.	10 LB. CHICKEN LEG 1/4'S \$6⁵⁰ bag
				10 LB. PORK STEAKS \$1⁹⁹ lb.	10 LB. GROUND SIRLOIN \$3⁷⁹ lb.
				10 LB. GROUND CHUCK \$2⁹⁹ lb.	10 LB. GROUND ROUND \$3⁴⁹ lb.
				10 LB. CHICKEN NUGGETS \$20⁰⁰ pkg.	10 LB. KOEGEL VIENNAS \$40⁰⁰ box

BRIAN'S PRODUCE: 989-345-2891

MICHIGAN HONEYCRISP APPLES \$1⁴⁹ lb.	FALL SQUASH 59¢ lb.	FRESH APPLE CIDER \$3⁹⁹ gallon	DEER FEED BY THE BAG OR BULK	AVOCADOS 79¢ ea.
COOKING ONIONS 99¢ 3 lb. Bag	WALNUT MEATS \$4⁹⁹ lb.	PUMPKINS, GOURDS, INDIAN CORN, CORN STALKS FOR FALL DECORATION		ROMAINE HEARTS \$1⁶⁹ ea.
HOME GROWN TOMATOES 99¢ lb.	HARDY FALL MUMS 3/\$12⁹⁹	BUDWEISER & BUD LIGHT \$13⁴⁹ 20 pk. bottles + dep.	COORS LIGHT & MILLER LITE \$15⁴⁹ 24 pk. cans + dep.	VIN VAULT BOX WINE \$14⁹⁹ 3 liter box

Largest Selection of Clean Used Cars in Central Michigan

CERTIFIED 1.9% UP TO 36 Months

GM Certified Pre-owned Vehicles = 2 Oil Changes & Tire Rotations in 2 years + 12 Month or 12,000 Mile Bumper to Bumper Warranty.

USED CARS	USED SUVS	USED TRUCKS	USED VANS
2017 CHEVY IMPALA LT Silver, 19,000 Miles, Certified \$23,900	2018 CHEVY TAHOE 4X4 Black, 33,000 Miles \$48,900	2018 CHEVY SILVERADO DOUBLE CAB Black, 27,000 Miles, 4x4, 5.3 V8 \$30,900	2017 DODGE GRAND CARAVAN SX White, 33,000 Miles \$21,900
2016 BUICK REGAL Burgundy, Leather, Sunroof, Turbo, 1-owner, 16,000 Miles \$21,900	2018 JEEP CHEROKEE 4X4 Gray, 24,000 Miles \$23,900	2018 CHEVY SILVERADO DOUBLE CAB Light Gray, 35,000 Miles \$20,900	2017 DODGE GRAND CARAVAN SX LT Light Gray, 35,000 Miles \$20,900
2015 BUICK LACROSSE CXL Dk. Chocolate, 35,000 Miles \$19,900	2018 FORD ESCAPE AWD Blue, 17,000 Miles \$23,900		
2015 CHEVROLET CRUZE Black Granite, 31,000 Miles, Great M.P.G. \$13,900	2018 CHEVY EQUINOX AWD LT White, 13,000 Miles \$26,900		
2014 CHEVROLET IMPALA LTZ Dk. Grey, 110,000 Miles \$8,900	2017 CHEVY EQUINOX LT AWD Blue, 13,000 Miles, Certified \$24,900		
2013 BUICK REGAL Black, 62,000 Miles, Nice Car \$13,900	2017 CHEVY EQUINOX LT FWD White, 18,000 Miles \$21,900		
2012 BUICK LACROSSE Goldmist, 4 Cyl, 92,000 Miles \$10,900	2017 CHEVY EQUINOX LT FWD White, 30,000 Miles \$20,900		
2011 BUICK REGAL CXL Majestic Blue, 69,000 Miles \$11,900			
2009 PONTIAC G6 Dk Blue, 211,000 Miles, Great Transportation \$4,900			
2016 BUICK ENCLAVE AWD CXL Iridium, 36,000 Miles \$31,900			
2016 BUICK ENCORE AWD Coastal Blue, 18,000 Miles, Certified \$20,900			
2015 BUICK ENCLAVE CXL FWD Champagne Silver, 24,000 Miles \$28,900			
2015 CHEVY TRAVERSE LT AWD White, 30,000 Miles, 7 Passenger \$25,900			
2015 GMC ACADIA SLE Dark Blue, FWD, 45,000 Miles, Certified \$23,900			
2015 GMC TERRAIN SLT AWD Blue, 45,000 Miles \$21,900			
2015 GMC TERRAIN SLE FWD 4 CYL Silver, 32,000 Miles \$20,900			
2015 CHEVY EQUINOX FWD LT Crystal Red, 23,000 Miles, Certified \$20,900			
2015 GMC TERRAIN SLE FWD Iridium, 57,000 Miles, New Tires \$16,900			
2014 BUICK ENCLAVE CXL FWD Mocha, 96,000 Miles \$19,900			
2014 GMC TERRAIN FWD SLE Black, 21,000 Miles \$17,900			
2013 TOYOTA RAV 4 XLE AWD Silver, 88,000 Miles \$15,900			
2011 JEEP WRANGLER 4X4 RUBICON Burgundy, 106,000 Miles \$18,900			
2018 CHEVY COLORADO CREW CAB 4X4 Silver Ice, 24,000 Miles \$30,900			
2017 CHEVY DOUBLE CAB SILVERADO 4X4 5.3 V8, White, 30,000 Miles \$30,900			
2016 DODGE RAM 1500 SPORT CREW White, 4x4, 69,000 Miles \$28,900			
2016 CHEVY DOUBLE CAB LT 4X4 Silver, 48,000 Miles \$28,900			
2015 GMC SIERRA CREW CAB SLE Black, 4X4, 31,000 Miles \$33,500			
2015 CHEVROLET SILVERADO CREW CAB LT Summit White, 32,000 Miles \$31,900			
2015 CHEVROLET SILVERADO DOUBLE CAB 4x4, 56,000 Miles \$27,900			
2014 CHEVROLET SILVERADO CREW CAB High Country White, 79,000 Miles, Navigation, Leather \$32,900			
2014 CHEVY SILVERADO DOUBLE CAB 4X4 Red, 110,000 Miles \$21,900			
2012 GMC EXT CAB SLT White, 107,000 Miles, Leather, 5.3 V8 \$19,900			
2011 GMC SIERRA EXT. CAB SLE Gray/Green, 5.3 V8, 4X4, 59,000 Miles \$19,900			
2004 GMC SIERRA CREW SLT 4X4 Black Duramax, Diesel, 170,000 \$14,900			

BENCHLEY BROS., INC.

1 Mile East of Doherty • US-10, Clare • Sales (989) 386-9900

HOURS
8-6 Mon-Fri
9-2 Sat



For more info log on to: www.benchleybros.com

Parts & Service (989) 386-3197



Summer is here

Building Materials for Your Projects:

Lumber, OSB, Treated Posts

Trusses, Windows, Doors,

Concrete Blocks, Mortar,

Redi-mix Concrete

Large Selection of Oregon Lawn Mower Blades In-Stock

Starting at **\$8.95**

OREGON



- Compost • Potting Soils
- Seed Starter
- Plant Mixes & More!



Welcome to the Big Green Egg® the Original American Designed Ceramic Cooker
A Smoker • A Grill • An Oven

COMPLETE OUTDOOR COOKER



10% OFF REGULAR RETAIL PRICES

- Chain saws
- Trimmers
- Blowers



HERSHBERGER'S PRO HARDWARE

10289 N. Leaton Rd., Clare, MI 48617-9107

(989) 386-5338

Full Line of Hardware & Building Supplies
Stove & Furnaces All Fuel Chimneys

GET MORE BANG FOR YOUR BUCKS FIREARMS



Crossbows & Crossbow Gear

Muzzleloaders and Muzzleloader Gear

Broadheads • Soft Cases
Bolts • String Wax & More

Pyrodex
209 Primers
Power Belt Bullets
Percussion Caps & More

Tested & Inspected. Why Pay New Prices?

GLADWIN TRADE & SALES

1-989-426-6811

1739 N. State St. • Gladwin

Shop Locally for Fall!

GM CERTIFIED PRE-OWNED SALE

- 172 Points Inspection
- 6 year/100,000 Mile Limited Warranty
- 24/7 Road Side Assistance
- Up to 3 months of OnStar/XM Radio
- 3 day/150 Mile Exchange Policy
- Up to 1.9% APR financing to well qualified customers through GM Financial

2018 Chevrolet Silverado Double Cab LT 4X4



Power Windows, Power Locks, 5.3 L V-8, Back Up Camera

Starting AT **\$29,995**

2017 Chevrolet Impala Premier



Leather Loaded, Back Up Camera

Starting AT **\$28,995**

2018 GMC Sierra Short Box Reg. Cab SLE



Loaded, All Terrain, Back Up Camera

Starting AT **\$35,925**

2018 GMC Acadia SLT All Terrain



Leather Heated Seats, Loaded, Back Up Camera

Starting AT **\$36,980**

2018 Chevrolet Malibu 4DR LT



Loaded, Back Up Camera

Starting AT **\$25,729**

2017 GMC Yukon Denali



Leather, Loaded, Back Up Camera

Starting AT **\$54,995**

2018 GMC Sierra Pick Up Double Cab SLE



Leather Loaded, Back Up Camera

Starting AT **\$36,550**

2018 GMC Canyon Crew Cab 4X4



V-6, Back Up Camera, SLT

Starting AT **\$36,571**

2018 GMC Terrain SLT Diesel



Leather Loaded, Back Up camera

Starting AT **\$32,995**

Plus Tax Title Plate Doc Fee. CRV Fee Must Finance with GMF to Get 1.9% Rate w/ Approved Credit

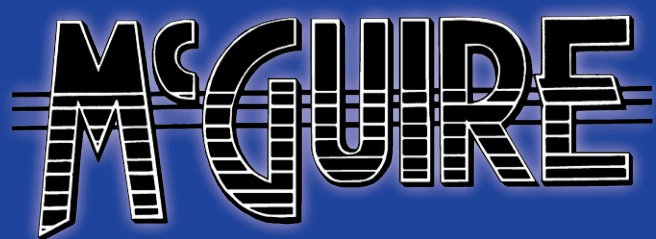

75 YEARS STRONG! | FIND NEW ROADS

712 W. 5th Street, Clare
www.McGuireChevrolet.com



989-386-7714

12 Months Interest
Free Financing Available
With Approved Credit.

\$300 Minimum purchase,
 monthly payments required.

LARGEST RECLINER
SELECTION IN MICHIGAN!
SEE FOR YOURSELF!

IN STOCK AND ON SALE NOW:

- Power Recliners
- Leather Recliners
- Big Mans Recliners
- Ladies Recliners
- Gliding Recliners
- Swivel Rocker Recliners
- Wing Chair Recliners
- Heat & Massage Recliners
- Lift Chair Recliners
- Reclining Loveseats
- Reclining Sofas
- Children's Recliners



Kubin's Furniture & Mattresses

101 N Mill St, Corner of M46, St. Louis, Michigan, (989) 681-5043
 Hours: Mon-Thurs: 9-6, Fri: 9-8, Sat: 9-5, Closed Sunday
 Sign up Your Email at: <http://www.kubins.com/signup.htm>



*SEE STORE FOR DETAILS

Lambert's Meat Market and Bakery

Taste the difference "FRESH" makes!

624 E. Cedar Ave., Gladwin (next to Family Dollar) **989-246-1850**



New Hours: Mon-Friday 8-6:30; Saturday 8-6; Sunday 8-4:00 • Sales Dates Monday, September 24 through Saturday, September 29, 2018



Believe on the Lord Jesus Christ and thou shalt be saved....Acts 16:31

f LIKE US ON FACEBOOK!
LAMBERTSMEATMARKET.WEBS.COM

10LBS OR MORE SALE!

Family Pack Ground Beef Hamburger 73% Lean
\$2.29 lb.

Family Pack Ground Beef from Chuck
\$2.69 lb.

Thick or Thin Bacon
\$3.99 lb.

Dearborn Little Link Sausage
\$21.90 6 lb. box

Pork Steak or Pork Strips
\$1.79 lb.

Breakfast Sausage or Shoulder Roast
\$1.79 lb.

Center Cut Pork Chops or Country Style Ribs
\$1.79 lb.

USDA Choice Denver Steaks
\$3.29 lb.

USDA Choice English Roast
\$3.29 lb.

Extra Lean Ground Beef from Round
\$3.69 lb.

GRILLING SPECIALS

BAKERY AND DELI DEALS

Whole NY Strip Loins
\$3.99 lb.
 CUT FREE!

Whole NR Ribeye Loins
\$4.69 lb.
 CUT FREE!

Marinated NY Strip Steaks or Beef Kebobs
\$5.99 lb.

Marinated Chicken Kebobs
\$4.99 lb.

Bakery French Bread "Great for Super Subs"
\$1.19 ea.

Iced Cinnamon Rolls
\$3.99 ct.

Jumbo Gourmet Caramel Apples
\$2.49 ea.

Dearborn Smoked Kielbasa
\$14.99 3 lb. pk.

Whole Boneless Pork Loins
\$1.99 lb.
 CUT FREE!

Lambert's Own Loaded Potato Brat or Sweet Apple, Onion, Bacon Brats
\$3.49 lb.

Whole Extra Lean Eye of Round GREAT FOR JERKY!
\$4.49 lb.

Kretschmar off the Bone Honey Ham
\$4.99 lb.

Deli Provolone Cheese
\$3.99 lb.



Bred Heifer Auction & Guest Consignors
Friday 9-28-18 11AM
Croswell Stockyards
5678 Black River Rd
Croswell, MI

- 85 Holstein Heifers
 - Bred 30 Days to Springers
 - Many Bred AI, DHIA Records
 - Vaccinated

200

Holstein Heifers Sell

Groups Include
 30 AI Sired Breeding Size
 - Bodeis

We are expecting several groups of springers & open heifers, Call today to list your cattle on this sale or for more information Trucking & Lunch Available Catalog & More Information at www.kreegerdairy.com
 Sale Co-Managed By

Kreeger
 and Associates, LLC

Chad Kreeger 517-294 3484

Croswell Stockyards
 Ryan O'Connor 810-537-1829
 Jim O'Connor 810-404-5954



Place Your Bid!

FARMLAND AUCTION
 40 Acres Prime Farmland * Shepherd, Michigan

Sale to be held at Maple Leaf Banquet Room, Downtown Shepherd, Michigan. Located at 320 W. Wright Ave. (next to Shepherd Bar). Isabella County.

WEDNESDAY, OCTOBER 10 *6:00PM*

- 40 Acres Prime Farmland
- 39.7 Tillable Acres
- Excellent Londo & Parkhill Loam Soils
- Complete System Tiled w/Plastic, 4 Rod Spacing, 12" Main Outlet. Maps Furnished
- Not Enrolled in PA-116
- Not Rented for 2019
- Close to Downtown Shepherd
- All around good, Productive Farm

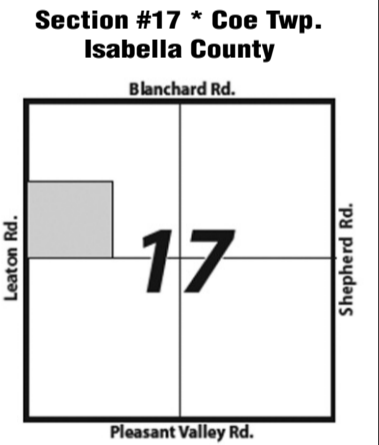

Please see www.PavlikLLC.com for all maps, aeriels, tax info and information.

Feel free to inspect the farm at your convenience.

Directions to the farm: Just west of downtown Shepherd on Blanchard Rd. to Leaton Rd. Turn south ¼ mile to the farm

Terry & Kathie Turnwald, Owner

CALL AUCTION COMPANY FOR MORE INFORMATION 989-463-4903

PAVLIK AUCTION SERVICE

JOHN PAVLIK & JOHN C. PAVLIK, SR.
 AUCTIONEERS/REALTORS

Pavlik Auction & Real Estate, LLC., Alma, MI 48801 • www.pavlikLLC.com

WEISS LIVING ESTATE AUCTION

Due To Health Issues, The Living Estate Of Denis Weiss Will Sell At Public Auction. Located: 8 Miles East Of West Branch On M-55 To Rifle River Trl., Then South 2 Miles To Rifle River Trl. B.L. (Lk. Ogemaw Business District), Then East & North ¼ Mile To N. Ogemaw Trl., Then East 1 Block To Totem Cross, Then South 2 Blocks To 2980 Arrowhead Trl.

West Branch, MI

Sunday September 30, 2018 • 11:00 A.M.

Quality Firearms, Ammo., Gunsmithing & Related Items: Marlin #1895LTDII Lever Action 45-70 Govt. Rifle W/ Oct. Bbl. (Nice) • Marlin #1894C Lever Action .357 Mag. Carb. Rifle • Marlin #1894S Lever Action .44 Mag. Carb. Rifle • Marlin #1894S Lever Action .45 Colt Rifle • Marlin #39A Lever Action .22 Rifle • Marlin #56 Lever Action 22 Rifle • Winchester #94AE Lever Action 45 Colt Rifle • Winchester #94 Lever Action 30-30 Win. Rifle W/ 24" Bbl. • Ruger 10/22 Semi-Auto. Carb. Rifle • Ruger 10/22 Semi-Auto. Rifle W/ S.S. Bbl. • Vintage 1935 Steyr/Austria #M95 747 Bolt Action Rifle W/ Bayonet, Unfired, Mossberg #500E .410 Ga. Shotgun • **Hand Guns,** Require CPL/To Include; S&W #19-5 .357 Mag. Revolver (Nice) • **Colt/Walther #1911** Govt. Rail .22 Cal. Pistol • Colt #CC5140 .22 Cal. Pistol • Remington #1911 .45 ACP Pistol • **Ruger Vaquero Model .45 Colt Revolver** • Ruger Mark I-Target .22 Cal. Pistol • Ruger Single Six Stainless .22 Cal. Revolver • Ruger Single Six Old Model .22 Cal. Revolver • Webley MKIV .38 S&W Revolver • H&R Sportsman Single Action .22 Cal. Revolver • Kel-Tec #P-32 .32 Pistol • Thompson Contender W/ 30-30 Win. S.S. Bbl. • Thompson Contender 7-30 Waters Carb. Bbl. • Thompson Contender 45/410 Bbl. • Thompson Contender .22 Bbl. • CVA Navy Colt Model .44 Mag. Black Powder • **Thousands Of Rds. Of Ammo. To Include;** 223, 9mm Luger, .380 45 Auto. 22 Cal. 22 Mag., 7.62x39, 5.56x45, .410 Ga., 12 Ga. & Lots Of Reloads • Vintage Ammo. • (3) Machesets • (4) Pellet Pistols • Old B.B. Guns • **Gunsmithing, Reloading Equip., Machinist & Related Accessories To Include;** Craftsman 6" Precision Metal Lathe (Nice) • Dake #1 Arbor Press • Delta Buffer & Pedestal Grinder • Gun Vise • Case Tumbler • Gunsmithing Table • Lee Reloader W/ Dies • (2) 7 Drawer Tool Boxes, Loaded W/ Gunsmithing Related Items • Several Scopes • AR Parts • Scope Rings • Magazines/Clips • Gunscrew Asst. Kit • Checkering Set Kit • Gunsmithing Wrenches • Screw Driver Sets • Gunsmith Sharpening Kits • Specialty Gunsmithing Hammers, Stones, Files, Pliers, Brushes, Etc. • Borescope Kit • Many Gun Cleaning Related Oils & Cleaners • Gun Primers • Gun Powder • Bluing Items • **Quan. Of Brass** (For Most All Cal. Of Firearms) • Gun Powder Supplies • Gun Organizers W/ Gun Related Parts • Several Firearms Books. • Targets • Gun Cases • Ryobi Temp. Gun • Die Grinders • Several Dremel Tools • Vernier Calipers & Digital Calipers • Dial Indicators • 1-2-3 Blocks • Number & Letter Hand Stamps • Taps & Dies • Mic's • Dowel Pins • Wiggler Set • Indicator Stands • Small Precision V-Blocks • Precision Levels • Much More That Was Neatly Packed Away • **Pontoon Boat, Paddle Boat, Lawn Tractor, Tools & Misc.;** Sweetwater 20' Pontoon Boat W/ 25 H.P. Mariner Motor • Alum. Paddle Boat W/ Canopy • Cub Cadet Riding Lawn Mower W/ Mower Deck • Pull Type Lawn Roller & Spreader • Lots Of Hand & Power Tools • (2) 5 Pc. Patio Sets • Lots Of Plumbing & Electrical Supplies • **Household, Pinball Machines, Antiques & Collectibles;** Solid Oak China Hutch • Drop Leaf Server • 3 Tier Bookcase • Lots Of Box Lots & Small's • (2) **Gottlieb's Vintage Pinball Machines,** 1 Working, Other Needs Work • Vintage Cameras • Complete Kenwood Stereo System • **This Is A Partial Listing! Auctioneers Note;** Denis Is A Well Respected Retired Engineer. He Worked For Numerous Major Corp. Throughout His Career. Denis Also Always Had A Passion For The Firearm Business. Make Plans To Attend This **Good Auction** On Lake Ogemaw. **Terms Of Sale;** Cash, Check Or Credit Cards Accepted.

TO VIEW A COMPLETE LISTING WITH PHOTO'S VISIT JOHNPECKAUCTIONS.COM

The Denis Weiss Living Estate
 2980 Arrowhead Trl., West Branch, MI
JOHN PECK AUCTIONS LLC
 Gladwin, MI (989) 426-8061

FALL CONSIGNMENT AUCTION

Saturday, Sept. 29, 2018 at 10:00 am

Located: Trufant Flea Market Grounds From GrandRapids OR Big Rapids on US131 to Exit 110 (Sand Lake), E through Sand Lake to stoplight, N on Federal Road to Stanton Rd, E to Trufant. OR M91 S of Lakeview OR N of Greenville to Stanton Rd, W to Trufant.

303 North C St, Trufant MI 49347, Montcalm County Follow Auction Signs

NO BUYERS PREMIUM CHARGED

- Guns (sell @ 10am)**
 Rem M6, 22 Takedown - Savage 1912, 22 semi auto
 Browning Citori Superposed 12ga - Win 1903, 22 semi auto
 Glenfield M25, 22LR - Rem 514, 22 bolt action
 Kodiak 22 mag, semi auto - Colt AR15, 223/556
 Dornoulin 12ga, SxS - Rem Target Master, 22LR
 Win M190, 22 semi auto - Rem 514, 22LR
 Anderson AR15, new - Stevens 335, 12ga, coach gun
 Weatherby PA-08, 12ga, new - Moss 183KA, 410 bolt
 Rem 597, 22 mag - Savage Axis 30/06, SxS
 Rem 141, 35 rem pump - Rem 740, 30/06, semi auto
 Win M14, pellet rifle - Rem 597, 17 HMR, semi auto
 Ruger Mini 14, .223 - Rem 7800, 30/06 pump
 Ruger 10/22 carbine - Rem M12, semi auto, 12ga
 Win 1911, 12ga, semi auto - Browning 12ga, pat. 1905
 Rem 770, 243 - BSA 12ga, semi auto - Rem 770, 270
 Henry Golden Boy 22LR, lever action - Win 94, 30/30, lever
 Hawk M 982 Home Defence 12ga - IBM MI Carbine, 30 cal
 Springfield 187, 22 semi auto - Ruger 10/22 Bullpup, 22 semi
 Rem 870 Express Mag, 12ga slug gun - RemM31, 20ga pump
- Tractors - Farm Equipment - Vehicles Trailers - Misc. (sell @ noon)**
 Ford Jubilee PS, good paint & tires - IHC 340 Gas w/loader
 ACWD 45, runs good - 1998 Ford 150, 4x4
 Trailworth 36' tandem dual gooseneck trailer w/ ramps & winch
 6x8 Utility Trailer - JD 215, 14" disk - JD 7' back blade
 4x8 Utility Trailer - JD 215, 14" disk - JD 7' back blade
 Kilbros 350 Gravity Box on JD 1065 gear
 Lucknow 6' 3pt. snowblower - 9 sec Drag - Oliver 1 btm Plow
 20x30 Canopy Tent - Lincoln 225 Welder - Misc. Tools
 Stihl Chain Saws - Silver ½ & 1 Dollar Coins - Steam Whistle
 Milk & Cream Cans - Nice Stone Boat - Cast Iron Seats
 Forks - Shovels - Battery Charger

Many Items too Numerous to Mention NOT RESPONSIBLE FOR NO SHOWS

There will be many more items not listed that will be consigned on Thursday & Friday before the sale. No consignments on Saturday will be accepted. Flea Market will be open. Loader on grounds at noon on Thursday and all the rest of the weekend.
Guns sell at 10 am & Tractors and equipment at Noon

Bows
 Bear Grizzly 58", 39# Recurve Bow, M6P9273
 Indian Archery Deerslayer 60", 40#, Recurve Bow

Terms: Cash or Good Check with ID. Credit and Debit cards accepted with a 2.75% fee added. Not responsible for personal injury accidents or goods after they are sold, everything sells as is, all information believed to be correct but it is not a guarantee. Use your own good judgement and inspection when purchasing. Announcements made sale day take precedence over printed material. Auctioneers act as selling agents only. Lunch wagon, restrooms available.

PETERSEN AUCTION SERVICE

Mike: 231-598-1029 • petersenauctionservice@gmail.com

AUCTION 2 Auction Rings!

Janice Hatt has decided to sell the following items at public auction located at 10803 S. Brinton Rd. Blanchard MI. 49310.
Directions - From Blanchard - travel east 4 miles on Blanchard Rd to Brinton, then south 2 ¼ miles to sale site. From Edmore - travel east 1 ½ miles on M46 to Deja Rd, then north 5 ¼ miles to sale site (Deja turn into Brinton). Watch for Pioneer Auction Signs!

Friday, September 28th @ 1pm

- 2001 For Thunderbird, 2 door, 2 seater, 68,319 miles, V8 eng, auto trans, hard and soft top, Vin#1FAHP60A62Y105405 Very Sharp!
- 2005 Chevy Avalanche 271, 4WD, 4 door, 209,713 miles, 5.3 ltr gas eng, auto trans, hard box cover, after market stereo, newer MasterCraft tires, Vin#3GNEK12Z65G263864

MOTORCYCLE • TRACTORS/IMPLEMENTS • GUNS/ SPORTING GOODS • BOATS/GO-KART • HOUSEHOLD/ANTIQUES/COLLECTIBLES • HOT TUB/BIKES/EXERCISE EQUIPMENT • SHOP TOOLS • LAWN & GARDEN • MISCELLANEOUS ITEMS



HATT PERSONAL PROPERTY AUCTION

Auctioneers Note: We hope you'll come out and join us for this country auction. This auction sale has it all from modern everyday items to some hard to find antiques and collectibles. Sale will take place rain or shine with plenty of shades/trees if needed. There will be 2 rings running so please bring a friend! Guns sell @ 3pm followed by cars!
Terms and Conditions: Cash, good personal check with proper ID, accepting Visa, MasterCard and Discover w/ a 3% processing fee. All out of state checks must have a letter from bank verifying funds. All property to be settled for day of sale. No property to be removed from premises until settled for. Not responsible for accidents or goods after sold. Auctioneers and sale personnel act as selling agents only and assume no liability or warranties what so ever. All items sold as is.

PIONEER AUCTION SERVICE, LLC

For more pics and info visit us on www.pioneerauctionservice.com

Lakefront Real Estate & Personal Property BECKER ESTATE AUCTION

The Following Real Estate & Personal Property Will Be Offered At Public Auction. Located: Approx. 5 Miles North Of The Houghton Lake State Police Post On Old 27 To Bradford Dr., Then East ¼ Mile To E. Houghton Lk., Then Turn Left & Go 4 Miles (Winding Rd. Along The Lake). OR From M-18 & CR. 100 In Prudenville (Randy's Family Restaurant), Go North & West 5 Miles To E. Houghton Lk. Dr.(CR. 300), Then Turn Left & Go 3 Miles. (Watch For Byers Lane, Arrived).
Lakefront Home • 66 Mustang • Shop Tools • Household • Antiques • Collectibles •

Houghton Lake, MI

Saturday, September 29, 2018 • 10:00 A.M.

Real Estate (To Be Auctioned At 12:00 Noon): 3 Bedroom 2 Bath Waterfront Home With Approx. 60 Ft. Of Houghton Lake Water Frontage. **Home Also Features;** A Extra Lot, 60' X 167' With 24' X 40' Pole Building. For More Info., Terms Of Sale, Or Showing Call/Text John @ (989) 426-8061.

PERSONAL PROPERTY

1966 Mustang, Boston Whaler Boat, J.D. Lawn Tractor, Tools & Misc. Items: 1966 Ford Mustang Coupe, 289 Motor, Solid Body, GT Grill, Needs Restoration • 1998 Boston Whaler 15 Rage Boat, V-6, 175 H.P. I.O. & Trailer • J.D. 212 Riding Garden Tractor W/ 42" Mower Deck & Front Snow Blade • Pull Type J.D. Trailer • J.D. Self Propelled Lawn Mower • Razor Elec. Scooter (Like New) • Acetylene Torch Set • Lincoln 225 Amp Welder • Air Compressor • Craftsman 10" Table Saw • Beaver Joiner • Bench Top Wood Lathe • Ryobi 12 5/16" Precision Surface Planer • Numerous Power Tools To Include; Sawzall, Grinders, Bitcut Joinder, Porta Band Saws, Skill Saws, Sanders, Routers, Jig Saws, Drill Motors, Etc. • Miter Saw • Chain Fall • (3) Chain Saws • Numerous C-Clamps • Several Hammers • Numerous Other Hand Tools • Several Asst. Yard Tools • Parts, Pipe & Scrap • Much More That Is Packed Away In Buildings • **Lots Of Antiques & Collectibles:** Primitive Hutch • Library Table • Drop Front Office Desk • Wooden Cabinets • Many Tables, Chairs, Mirrors, Pictures, Etc. • Large Framed Mirror • Wooden Benches • 4 Pc. Blonde Bedroom Suite • Drop Leaf Table • Cedar Chest • Tiffany Style Table Lamps • Vintage Hanging Lamp W/ Prisms • Hanging Oil Lamp W/ Wrought Iron Hardware • Leaded Glass Windows W/ Old Wooden Frames • Vintage Lanterns • Wrought Iron Floor Model Ash Tray • 3 Drawer Carpenter Box • 3 Way Lighted Traffic Light • Mobil & Standard Adv. Gas Station Cans • Numerous Metal Toy Trucks, Cars, Planes, Buck Rogers Battle Cruiser, Cannons, Etc. • **Numerous Antique Tools To Include;** 2 Man Saws • Hay Knives • Barn-Beam Drill • Can't Hook • Carpenter Planes • Log Tongs • Ice Tongs • Grub Hoe • Boring Augers • Sickle Knives • Hand Planters • Corn Sheller • Sausage Stuffer • Cast Iron Dutch Ovens • Copper Boiler • Set Of Snow Shoes • (2) Bear Kodiak Recurve Bows • Several Arrows W/ Quiver • Old Fishing Rods • Old Boat Motor Cart • Old Tackle Boxes • Model A Lights • Model A Radiator Covers & Running Boards • Ox Yoke • 1,800 Clay Marbles • Several Of Marbles • Clay Jug • Crocks • Enamel Kerosene Heater • Erector Set • Old Books • Texas Long Horns • **Household Related:** Dining Table W/ 6 Chairs • Several Living Room Chairs • Several Lovers • Rocker • Davenport • Lloyd's Restroom Patio Chairs • Nesting Tables • Pots & Pans • Glassware & Dishes • Lots Of Box Lots • **This Is A Partial Listing! Auctioneers Note;** Make Plans To Attend This Good Sale On Houghton Lake. Your Attendance At The Becker Estate Auction Is Appreciated.

TO VIEW A COMPLETE LISTING WITH PHOTO'S VISIT JOHNPECKAUCTIONS.COM

Bill & Clista Becker, Owners
 9003 E. Houghton Lk. Dr., Houghton Lake, MI.
JOHN PECK AUCTIONS LLC
 Gladwin (989) 426-8061

AUCTION



ESTATE AUCTION

To settle the estate of William (Bill) and Shirley Burns the following will be offered at Public Auction. Located: 2 Miles East of Clare on Pere Marquette Rd. "Old US-10" to Summerton Rd, South 2 miles to Beck Rd, East 1/2 mile to Sale Site. 6302 E. BECK ROAD, CLARE, MI 48617. Follow Yoder Bro. Auction Signs!

SATURDAY, SEPTEMBER 29th, 2018 @ 10:00 A.M.
CLARE, MI 48617



CAR, TRACTOR and FARM EQUIPMENT

- BUICK LUCERNE CXL 4 Door Car, Dark Grey, 45,591 Miles, Very Clean Cond.
- JOHN DEERE 5210 Loader Tractor, Diesel, Sync Shuttle Shift, 16-9-28 Tires, 3pt, Hyd Outlets, 2705 Hrs., Good Cond. • 3pt 10' TRIPLE K Drag • I.H. 350 3pt 3 Bot. Plow • 3 pt, 2 Bot. Plow • Quick Attach. Bale Spear • 3pt 6' Back Blade • Quick Attach. Tine Bucket

SHOP and OUTDOOR MISC ITEMS

- JOHN DEERE GT 235 48" Riding Mower • C-M 2700 psi Pressure Washer • Deer Blind • 1000 Gal Propane Tank • Portable 25 gal Air Compressor • Parts Washer • C.M. Shop Vise • 6" Bench Grinder • Portable Air Tank • SCHMUCHER Battery Charger • 2 Ton Floor Jack • Wood Gilder Bench • Patio Bench • LifeTime Picnic Table • Lawn Chairs • Wheel Barrow • STIHL FS45 Weed Eater • Push Mower • Garden Hose • Woven Fence • Sheep Crate • Wood Sheep Feeder • Wood Feed Bin • Log Chains • Center Links • Hyd Cylinders • Comalong • Grease Guns • Pipe Wrenches • Tool Cabinet & Tools • Open End Wrenches & Misc Shop Tools • Metal Gas Cans • Nails & Screws • Rakes, Forks and Shovels • MISC GOODIE WAGON!

FURNITURE and HOUSEHOLD

- 5 pc Quality Oak Bedroom Set, Queen Pillow Top Bed, Dresser, Chest of Drawers, 2-Night Stands • Oak Table and 4 Chairs • Table w/4 Oak Chairs • Kitchen Hutch • Oak Glass Door China Cabinet • 2 - Blue Recliners • Floral Pat. Couch • Oak Glider Rocker • Oak Padded Rocker • Like New L.G. Maxi Recliner Lift Chair • Oak Child's Chair • Oak Coffee Table • 2 - Oak Queen Ann Lamp Tables • Oak Entertainment Center • Dresser w/Matching Chest of Drawers • Queen Size Bed • Single Bed • Oak Toy Box Bench Combo • SAMSUNG 32" Flat Screen TV • TOSHIBA Flat Screen TV • ELGIN Wall Clock • GIBSON Upright Freezer • MAYTAG Digital Dryer • WHIRLPOOL Washer • Country Bell Wall Phone • COCA COLA Collector Tray • BISSELL Vacuum Cleaner • 100+ PRECIOUS MOMENTS Figurines with Boxes • Holiday Express Precious Moments Train Set and Many Others • Igloo Coolers • Canning Jars • Handmade Baskets • BEANIE BABY Collection • Fans • Autographed Photos and T-Shirts from Country Singers Include: Johnny Cash, Willie Nelson, Randy Travis, Loretta Lynn, Allen Jackson, Alabama, Faith Hill and Numerous other Country Singers • Boxes of Recipe Books • Kitchen Ware • Large Variety of Household Box Lots

FOR 100+ Photos see auctionzip.com I.D. 2701 or go to auction.com I.D. 2109

AUCTIONEERS NOTE: Tractor and car will sell at approximately 12 noon. Bring your troller and enjoy a good country auction with us! Hope to see ya there! Leroy

SEWING MACHINES and QUILTING MATERIAL

- 3 - SINGER Feather Weight Sewing Machines w/Case • WHITE MOD. 1740 Quilters Sewing Machine • MEMORY CRAFT 7000 Sewing Machine • 50+ Boxes of Quilting Related Items Include: Quilt Pieces, Quilt Patterns, Decorating Patterns, Embroidery Fabric, Christmas and Halloween Fabric, Quilted Fabric, Ribbons and Bows • Large Variety of Quilt and Sewing Patterns • Boxes of Yarn • Wooden Spinning Wheel • Sewing Table • 2 - Quilt Frames • Boxes of Pattern Books • Partial Listing, Many More Items Too Numerous to Mention!

ESTATE OF: WILLIAM (Bill) and SHIRLEY BURNS

Administrator: William Burns Jr

Yoder Brothers Auction Service

Specializing in Successful Auctions

Auctioneers LeRoy and Willis Yoder
9484 S. Rogers Ave., Clare, MI 48617
PH: 989-386-9082



Auction Terms: Cash or approved check with proper I.D. Nothing to be removed until settled for. Not responsible for accidents. Lunch on grounds. All announcements made day of sale take precedence over all materials. Out of state buyers must have bank letter of credit. Visa & Mastercard accepted with a 4% transaction fee.

FIND YOUR NEXT HIRE

WITH

MONSTER and Digital First Media



Finding great talent can be a challenge. Finding them nearby, even more so. Monster and Digital First Media have the technology and media solutions to help you reach, connect with and hire the best local talent. From social to mobile, print to the cloud, let us help you find the best hire, around the globe or around the corner. To learn more, visit www.theoaklandpress.com; www.heritage.com; www.dailytribune.com; www.macombdaily.com; and www.themorningsun.com

digitalfirst | MONSTER
MEDIA

Closeout 145th Anniversary Limited Edition Machine

Tribute™ | 145C

- 200 utility, specialty stitches including 4 built-in fonts
- Monochrome touchscreen
- Large sewing surface 200mm
- Automatic thread cutter

Special Purchase

\$799 While Supplies Last



Husqvarna

VIKING

OPAL™ 690Q

- Computerized Sewing & Quilting
- EXCLUSIVE SENSOR SYSTEM™
- Automatic Thread Cutter
- Bobbin Thread Sensor

NOW ONLY

\$999



Alma Sewing Center

301 E. Superior, Alma, MI 48801
(989) 463-3200



September Special
FELINE COMBO VACCINATION LEUKEMIA/CVR



Special **\$30⁰⁰** Reg. \$35.00
 By Appt. 426-0203
 Flexible Hours

KELLY'S KRUISSING KRITTER KARE
 Kelly Jo Kelley, DVM

CUSTOM DESIGNS Buy Direct & Save *Indoor Showroom*



Also Available
Cremation Vaults and Urns

Brewer Bouchey Monument Co.
 Family Owned Since 1895
 211 N. Mill St. • Downtown St. Louis
 989-681-3300 • Toll Free 888-362-2920
 Hours: Mon.-Fri. 9-5; Sat. By Appt.
 www.brewer-bouchey.com

JACK OF ALL TRADES COINS

1028 S. Mission
 (next to Jon's Country Burger)

I BUY ALL COINS Silver and Gold FREE APPRAISALS
 we will come to your home to do free appraisals for your convenience.
 Over 25 Years experience!

I BUY ALL COLLECTIONS
 FROM ONE COIN TO A DUMP TRUCK FULL

We are a Full Buy • Sell • Trade shop!
 ANTIQUES • COINS
 Jewelry • Collectibles & more!

Stop in or call Matt for your free appointment
517-204-0787

Do not take your coins, jewelry, gold, & silver to the we buy gold places they are not experts! We are your only experts! WE PAY YOU MORE THAN ANYONE!

LOCAL SHOPPING. LOTTA SAVINGS!

SAVE \$100 FOR EVERY \$1,000 spent on these Pet friendly flooring styles, up to \$1,000 in savings!

And, 0% interest financing, for up to 36 months - with approved credit and monthly payments.

Or, pay materials IN FULL at time of order, and save the Sales Tax, too!



MOHAWK

ALL PET PROTECTION & WARRANTY

FLOORING FOR ALL PETS

SAVE UP TO \$1,000

*SELECT FLOORING STYLES | *SPECIAL FINANCING AVAILABLE
 SEPTEMBER 6 - OCTOBER 18

Gratiot County's favorite floor store 18 straight years!

NEEDHAM'S Home Center
 Real Floors for Your Real Life Since 1977

945 W. Monroe Road (M-46), St. Louis, MI 48880 • Phone (989) 681-5393
 Hours: Mon.-Fri. 8:30am-5:30pm; Sat. 9am-3pm; Evenings by appointment



Central Eavestrouthing, LLC
 LICENSED & INSURED • FREE ESTIMATES

Manufacturers of...
 • 5" Seamless Gutter
 • 6" Commercial Seamless Gutter
 • Leaf Protectors

Quality & Service Are #1!

It's Gutter Cleaning Time!

.032 Gauge Aluminum Hidden Screw Hangers

QUALITY WORKMANSHIP FAST FRIENDLY SERVICE
 Job Gilbert • (989) 828-6279 • Shepherd, MI

A Greener Approach to Affordable Housing

Heather Court 400 E. Warwick Dr., Alma	Tartan Terrace 423 Gratiot Ave., Alma
--	---

Heather Court & Tartan Terrace
 1 bedroom apartments for Elderly & Disabled
 Amenities include:

- * Laundry facility on site
- * Utilities included
- * Monthly Activities/Outings
- * Secured Building/Surveillance
- * 24 Hour Maintenance
- * Reduced Cable fee
- * Smoke-Free Policy

Rent is based on 30% of monthly gross income.

Hampton Park
 on Penrith Street, Alma
Forest Glen
 on Euclid Ave., Alma

Hampton Park & Forest Glen have 3 & 4 bedroom family apartments
 Must qualify under HUD guidelines as a low-income household.

Alma Housing Commission
 is accepting applicants for 1, 3 & 4 bedroom apartments.
989-463-4200
 Downloadable application @ www.ci.alma.mi.us or stop in for an application

400 E. Warwick Dr; Alma
 Office Hours: Mon. - Fri., 9AM - Noon and 1:30 - 4pm

Housing Choice Voucher Program is now OPEN! No application fee



assisted **Living with Heart**

ARBOR GROVE Assisted Living

1320 Pine Avenue, Alma, MI 48801
 arborgroveassistedliving.com
 989.463.3074

Our residents, their families, and our staff have one thing in common - we genuinely care about each other. **We have heart.**

Share life's journey in a community that cares.

Offering Independent Living Duplexes (The Villas), Assisted Living & Moments Memory Care



Click! For The CLASSIFIEDS!



Fall Begins

Thank you for not driving buzzed last night. You saved my life.
Liz Osaki

SAVE A LIFE. DON'T DRIVE HOME BUZZED. BUZZED DRIVING IS DRUNK DRIVING.

Ad Council U.S. Department of Transportation



Fall Inventory Reduction Sale

STOP BY OUR LOT AND CHECK OUT THE GREAT SELECTION OF BUILDINGS ON THE LOT - READY TO GO!

RENT TO OWN 90 DAYS SAME AS CASH

 14x20 High Barn 8x7 Roll Up Door, 8 Ft. Loft Reg. \$4,725 SALE \$4,550 \$210.64/Month	 12x20 High Barn 2 Octagon Window, 8ft Loft Reg. \$4,150 \$4,000 \$185.18/Month	 10x16 High Barn 1 Window, 2 4ft Lofts Reg. \$3,160 SALE \$3,040 \$140.74/Month	 10x16 High Barn 1 Window, 2 4ft Lofts Reg. \$2,790 \$2,700 \$125/Month	 14x36 8ft Loft 64 ft Shelves, 2 Windows, Insulated 8x7 Garage Door, 6ft Side Door Reg. \$7,773 \$7,550 \$349.53/Month
 12x24 High Barn 8 Ft. Loft Reg. \$4,380 \$4,200 \$194.44/Month	 12x16 Gable 10 Windows, 4 Ft. Loft Reg. \$3,528 \$3,425 \$158.56/Month	 12x28 Cabin 8 Windows Reg. \$5,880 \$5,650 \$261.57/Month	 12x20 Cabin 5 Windows Reg. \$5,120 \$4,800 \$222.22/Month	 14x24 Gable 1 Window, 9x7 Rollup Door Reg. \$5,350 \$5,200 \$240.74/Month
 14x24 Gable 2 Windows, 8x7 Insulated Garage Door, 3' Entrance Door Reg. \$6,060 \$5,850 \$270.83/Month	 10x14 Chalet 10 Window Corners, 3 Windows Reg. \$3,170 \$2,850	 12x12 Gable Green Octagon Window, 2 Windows Reg. \$3,090 \$2,750 \$127.31/Month	 10x12 Gable Reg. \$2,480 \$2,400 \$111.11/Month	 10x12 1 Window Reg. \$2,220 \$2,150 \$99.53/Month
 12x16 High Barn 8 Ft. Loft Reg. \$3,060 \$2,970 \$137.50/Month	 12x14 High Barn 8 Ft. Loft Reg. \$2,860 \$2,780 \$128.70/Month	 10x14 Gable 10 Window & Door, 3' Loft Reg. \$2,595 \$2,500 \$115.74/Month	 10x14 Gable 1 Window Reg. \$2,400 \$2,320 \$107.40/Month	 8x12 Quaker 2 Windows Reg. \$2,230 \$2,120 \$98.14/Month

Statewide Delivery - Free Delivery w/ in 70 miles!

Supplying Michigan with quality built portable buildings for over 25 yrs.

Miller's Woodworking

ATTENTION: Deer Hunters We have Deer Blinds In Stock

3209 E. Beaverton Road • Clare
(Voicemail) 989-465-8172
Old US 127 to Surrey West on Surrey to Grant 1 mile north on Grant

Mon.-Fri. 7:30am-5:00pm
Saturday 8:30-3:00 & Evenings by Chance or Appointment
Closed Sunday

RE/MAX® Open Seven Days a Week to Serve You!
RIVER HAVEN, INC. www.riverhavenhomes.com
 Wayne R. Walts - Broker

Main Office
 777 W. Cedar
 Riverwalk Place
 989-426-6893

Wixom Lake Office
 1239 Estey Road,
 Beaverton
 989-435-7755

Sugar Springs Office
 1415 W. Sugar River Rd.
 Gladwin, MI 48824
 989-426-9239



Wixom Lake - 3 bedroom, 2 bath, 2 car garage, deck overlooking 62 ft of front on 2000 acre all sports lake. **\$99,900** MLS#170122

Sugar Springs - Newer 3 bedroom, 2 bath, 2 car att garage, double lot on the No 1 tee box. **\$154,700** MLS#170116

Mt. Pleasant Area - 3 bedroom ranch with att garage PLUS a 20x50 building all this and more on 69 acres. **\$325,000** MLS#170092

PRICE BUSTERS

DEWEY'S TRADING POST
 Maple Rapids • 682-4158
 Monday-Saturday: 8am - 7pm, Closed Sunday

Prices In This Ad Good for weeks of September 24, 2018 - September 29, 2018
 WIC • Bridge Card • VISA • Mastercard • Discover
 American Express • Debit Card & Chamber Bucks Gift Certificates.

Koegel's Ring Bologna \$3.69 LB.	Select New York Strips 13 lb. avg. \$4.39 LB.	"Smoked" Briskets (Sliced or Shaved) \$6.99 LB.
"Our Own" Beer & Cheddar, Ball Park, Regular Brats \$3.99 LB.	"Everyday" Choice T-Bone Steaks \$7.99 LB.	Choice Boneless Arm Roast \$3.49 LB.
Choice Boneless Patio Steak \$3.99 LB.	Choice Boneless Stew Meat \$4.99 LB.	10 LB. Leg 1/4s \$6.99 10 LB. BAG
"Bulk Bacon" Thick \$3.49 LB.	Bulk 5 LB. Bag Fresh Ground Chuck 80/20 \$17.45 A BAG	
"Our Own" Smoked Roasted Sausage \$6.99 LB.	"Our Own" Butt Bacon Reg & Peppered \$3.49 LB.	

CHECK OUT ALL OUR BULK FOODS FOR YOUR BAKING NEEDS

DeweysTradingPost.biz
 LIKE us on Facebook & see our WEEKLY SPECIALS!

PLEASE RECYCLE THIS NEWSPAPER

Country Corner MARKET **Bulk Food • Deli**
 2 Miles South of Rosebush • 2020 North Mission Mt. Pleasant • 989-433-8200
 8:30am-5:30pm, Monday-Thursday
 8:30am-7:00pm, Friday • 8:30am-4pm, Saturday

Large Selection of Freezer Food at Discounted Prices

SPECIALS OF THE WEEK

Walnut Creek Lacey Baby Swiss Cheese **Sale \$3.69** Reg. \$4.29 lb.

Walnut Creek Buffalo Chicken Breast **Sale \$4.39 lb.** Reg. \$4.89 lb.

MORE SPECIALS

Walnut Creek Cheese Shreds 8 oz. All Varieties **\$1.49 ea.**

Walnut Creek Puff Corn Cheddar or Butter **\$1.09 ea.**

Slow Cooker Seasonings All Varieties **4/\$5.00 or \$1.29 ea.**

Walnut Creek Pie Shells 2 ct. **\$2.49 ea.**

We have a large selection of Mums, Pumpkins and Fall Décor
Coffee of the week: Mocha Java

CALL NOW! BUY FACTORY DIRECT!

Houseful of Windows Only

\$1995

Complete With Installation*
 Plus Buy Our Premium Windows & We'll Add
FREE Low-E Glass & FREE Marble Sills!!
We Will NOT Be Undersold!
We carry Pella and Andersen windows
 That's Why Over 39,000 Homeowners Have Chosen Paramount



*Based on 7 double hung or slider windows up to 1200 sq. inches each. Includes basic installation.

FREE Gutters with Roofing + Siding That's A \$1600 Value

SIDING & ROOFING

INCLUDING METAL ROOFS
50% OFF
 Any Roofing & Siding Installation Labor

We Repair HAIL DAMAGE

WE OFFER NO INTEREST FINANCING OR NO PAYMENT UNTIL 2020

Factory Direct Windows



Don't Buy Until We Quote You
We Will Beat Their Price On Any Comparable Product!

Celebrating 27 Years of Business Since 1990

Paramount

HOME IMPROVEMENTS, LLC
 Statewide Coverage
 Windows • Siding • Sunrooms • Roofing

Call Us Today For Your Free Estimate!
1-800-288-4385

MasterCard VISA Discover American Express

License #2101109016



DON'T DELAY DRIVE TODAY!

See us at Hart of Roscommon



2011 FORD FUSION



2.5L I4 16V MPFI DOHC, Remote Trunk Release, Security System, #4442C

\$5,988

2010 FORD FUSION



4 Wheel Disc Brakes, AM/FM Stereo, Brakes-ABS-4 Wheel #4371C

\$6,988

2012 FORD TAURUS



4 Wheel Disc Brakes, AM/FM Stereo, Air Bag - Driver/Passenger, 4DR, Sedan, FWD, #4275C

\$9,988

2013 FORD TAURUS SHO TWIN TURBO



Hands-Free Communication System w/ Voice Control, BLIS, Black, #4425C

\$13,988

2011 FORD EDGE



Bucket Seats, Climate Control - Dual, Remote Keyless Entry #4461T

\$10,488

2015 FORD ESCAPE



Blue Tooth Communications, Brakes-ABS-4 Wheel, Bucket Seats, #4497T

\$14,988

2017 FORD EDGE



Blue Tooth Communications, Audio-Upgrade Sound System, AWD, Canyon Ridge Metallic, #4360T

\$27,988

2013 CHEVROLET EQUINOX



2.4L, 6-Speed A/T, 4 Wheel Disc Brakes Pioneer Sound System #4468T

\$11,988

2009 FORD ESCAPE



Additional Power Outlet(s), Audio-Satellite Radio, FWD, 4DR, V6, Auto, Black, #4392T

\$5,988

2014 FORD ESCAPE TITANIUM



Park Assist/Back Up Camera and Monitor, Remote Keyless Entry, 4WD, 4DR, #4426T

\$15,988

2015 FORD ESCAPE



Air Bag - Driver, Air Bag - Passenger, Air Bag - Side, #4493T

\$21,988

2008 FORD EXPLORER



4WD, CD Player, Intermittent Wipers, Traction Control, White Suede Metallic #4454T

\$8,488

2015 FORD EXPLORER



6-Speed Automatic, 4 Wheel Disc Brakes, Air Conditioning, Ingot Silver Metallic #4464T

\$24,988

2016 FORD EXPLORER



Rear Defrost, DownHill Assist Control, 4WD, 4DR, Black, #4428TR

\$30,988

2017 FORD F150



4 Wheel Drive, AM/FM Stereo, Air Bag - Driver, #4488T

\$33,988

2013 F150 SUPER CAB



4 Wheel Disc Brakes, 4 Wheel Drive, AM/FM Stereo, Additional Power Outlet(s), Air Bag - Driver #4471T

\$18,988

2014 LINCOLN MKS



4 Wheel Disc Brakes, AM/FM Stereo, Air Bag - Driver, Air Bag - Passenger, Air Bag - Side, #4480C

\$12,988

2018 FORD F150



Side Airbag, 2WD, A/T Reg Cab 8' Box, Parking Assist, #4408T

\$24,988

2016 CHEVROLET EQUINOX



Brakes-ABS-4 Wheel, Bucket Seats, Child Safety Locks, Cloth Seats, #4475T

\$19,988

2012 FORD F150



4 Wheel Disc Brakes, 4 Wheel Drive, AM/FM Stereo, Additional Power Outlet(s), Adjustable foot pedals #4410T

\$22,988

2001 FORD F-350 XL



7.3L V8 16V, Diesel, 4-Spd Automatic 4 Wheel Drive, #4407T

\$4,988

2010 FORD F150



4 Wheel Disc Brakes, 4 Wheel Drive, AM/FM Stereo, Additional Power Outlet(s), Adjustable foot pedals #4352T

\$13,988

2014 RAM 3500



4WD, Air Conditioning, Brakes-ABS-4 Wheel, Heated Side Mirrors, Black #4459T

\$43,988

2016 SUBARU FORESTER



4dr, CVT PZEV, 4 Wheel disc Brakes, All Wheel drive, Child Safety Locks #4443T

\$19,988

2015 FORD F150



4 Wheel Disc Brakes, 4 Wheel Drive, AM/FM Stereo, #4487T

\$30,988

Only 7000 Miles

2011 FORD F150



Air Bags - Head, Air Conditioning, Brakes-ABS-4 Wheel, #4462T

\$18,988

2004 FORD F150



Air Conditioning, Brakes-ABS-4 Wheel, Built-in Garage Door Opener, CD Changer, CD Player, Climate Control - Auto, #4245T

\$10,988

2015 LINCOLN MKZ



4 Wheel Disc Brakes, Air Conditioning, Child Safety Locks, Bucket Seats, Gray, #4356CR

\$17,488

2011 JEEP GRAND CHEROKEE



5.7L V8 16V, 73,036 miles, Black / Light Frost Beige #4457T

\$17,988

2005 MERCEDES-BENZ G-WAGON



4 Matic, 4DR, Remote Power Door Locks, Power Windows, Silver, #4404T

\$39,988

REDUCED



Hart Ford - Lincoln
117 Lake St., Roscommon, MI • 877-316-7189
www.hartfl.net

Business Card Directory

DELIVERY ISSUES: (989) 779-6000 PRESS 2

HANDYMAN BILL LEONARD

- General Carpentry
 - Repair • Maintenance
 - Home Improvement Projects
- E-mail: yourhandymanbill@yahoo.com
Licensed • References • Economical
(989) 681-2516

digitalfirst MEDIA

If you are located in Gratiot, Montcalm, Clinton or Saginaw Counties call today to schedule an in person meeting to discuss your advertising needs!

Vonda Ryckman
Account Executive
The Morning Sun • The Mid-Michigan Buyers Guide
vonda@michigannewspapers.com
For Advertising call **989-533-3105**
For Circulation call 989-779-6000 Press 3

**THIS SPOT
COULD BE YOURS:
CALL KINDRA**

(989) 506-4640
KNORLANDER@MICHIGANNEWSPAPERS.COM

CEMETERY MEMORIALS

Why Pre-Plan?



- Peace of Mind
- Makes it a Shared Decision
- Saves you Money
- Completes your Estate Planning

St. Helen-Roscommon Monument, Inc.
101 E. Federal Hwy-Roscommon
989-389-4921 • www.shmonument.com
Hours: Tues. - Fri. 10-4 and Sat. 10-2

VACUUM CLEANERS/SEWING MACHINES NEW & USED

FREE ESTIMATES Service On Most Brands

Circle Sewing & Vacuum Center

Sales • Services • Parts • Top Quality • Low Prices
Serving Midland For Over 50 Years
We Have It All!

1900 S. Saginaw Rd. • Midland
(989) 839-0800
In the K-Mart Plaza

HOURS:
M-F 9:30 - 5:30
Sat. 9:30 - 3:30

Bontrager's Metal Roofing LLC

The last roof you'll ever need!

Larry Bontrager
Free Estimates

(989) 418-9739
915 East Herrick Rd. Farwell

Big Or Small - We Do Them All!
FREE ESTIMATES

A & M
METAL ROOFING
989-487-9066

5023 Grass Lake Rd. - Clare

**CALL
KINDRA**
FOR YOUR ADVERTISING
NEEDS: (989) 506-4640

Valley Travel
of Mt. Pleasant, Ltd.

**FUEL YOUR SENSES
OF ADVENTURE
EXPLORE THE
NEW EXCITING
DESTINATION**

ICELAND
10 DAY ICELANDIC
ADVENTURE
SMALL GROUP
TOURS AVAILABLE

2018 - 2019
LANSING NON-STOP
CHARTER FLIGHTS
PACKAGES
AVAILABLE TO
CANCUN, JAMAICA
AND PUNTA CANA
AVAILABLE
DECEMBER 22 - APRIL 01

CALL FOR DETAILS

123 S Franklin St Toll-Free (800) 290-6714
Mt Pleasant Office (989) 773-9914

IT'S GRILLING SEASON
Make sure your propane tank is full

**20LB. CYLINDER FILL
\$11.00**

50% off ALL in-stock grill parts

GAS PRODUCTION Co., INC.
8512 E. M-46 - Vestaburg
989-268-5079 OR 800-991-7477
www.gasproductioncompany.com

OPEN: MON-FRI. 8AM - 5PM

**NEW MILLENNIUM
MORE THAN A
PAWN SHOP**

Serving Mt. Pleasant for 19 years with 40 years of experience

WE BUY ALL
Gold • Silver
Diamonds • Coins
FREE APPRAISALS

WE ARE THE
Guns, Tools, Electronics
and Jewelry experts!
We pay more than anyone
for your items!

**WE ARE A FULL BUY
SELL TRADE SHOP**
Jewelry • DVDs • Cameras
Musical Instruments & Equipment
Laptops • TVs • Tablets
Video Games & Systems
Sporting Goods & Archery Vehicles
Motorcycles & ORVs

OPEN
Mon - Fri 10-6
Sat 10-4

989.779.8822
5281 E. Pickard St., Mt. Pleasant, MI
Just West of US 127

**PROFESSIONAL
ROOF CLEANING** by **HAWKEYE
ROOF
CLEANING**

We also clean... • Patios • Fences • Driveways
• Decks • Siding • Swing Sets • And More...

CALL TODAY: **(989) 386-4196**
WILLIAM BYLER
7234 S. Grant Ave. Clare

"Our Customers are our Warmest Friends"
Guaranteed On Time and Certified
FREE TANK SETS

COYNE OIL & PROPANE
Clare • Harrison • Mt. Pleasant • Evart • Gladwin
Cadillac • Merrill • Interlochen
800-386-7731 • 989-386-7731

RESIDENTIAL • COMMERCIAL
INDUSTRIAL • FARM

North Country Metals, LLP

Count on us for ALL of your
pole barn building needs!

Metal Roofing & Siding

- All Steel Walk Through Doors
- Sliding Door Hardware
- Pole Barn Windows
- Moisture Barriers • Caulk
- Skylights • Fasteners • Roof Boots

989-386-3013
5139 Pere Marquette • Clare

NOW OPEN

**FOX
VENTURES**

Heavy Equipment Rental

Serving all of Central Michigan
Delivery Available

Perfect for the
Contractor
and Homeowner

We now offer:
Excavators
Dozers
Manlifts
Scissor lifts (indoor and all terrain)
Forklifts
Motorhomes
Campers
Pontoons

108 E. Third, Clare • (989) 424-6499

VALET AUTO CARE, INC.
Since 1983

- A.R.E. Pickup Toppers
- Over 100 New & Used Toppers in Stock
- Truck Accessories
- Tonneau Covers

LEER **A.R.E.** Because you love your truck
www.valetauto.com

James Motz - Owner
610 N. Mission (3 blocks S. of Meijer) Mt. Pleasant (989) 773-3477

**Log in.
We're open.**

Maury S Irwin, Agent
1011 N McEwan Street
Clare, MI 48617
Bus: 989-386-4141
maury.irwin.j8gz@statefarm.com

When you'd rather log in than walk in, check out our new mobile app. It's been redesigned with you in mind to help make your life even easier.
DOWNLOAD THE STATE FARM® MOBILE APP IN THE APP STORE OR GOOGLE PLAY TODAY.

State Farm

1708120 State Farm, Bloomington, IL

CAL'S PAINTING

Over 30 Years Experience
COMMERCIAL & RESIDENTIAL

- Interior & Exterior • Power Washing & Deck Care
- Window Washing & Gutter Cleaning
- Drywall Repair • Cleaning and Refinishing Log Homes
- Cabinet, Woodwork, Door & Furniture Refinishing

GO CALL TODAY!
(989) 258-9638

• Free Estimates • Work Gauranteed • Insured
Winter Rates Available

**NO JOB
TOO BIG
OR SMALL**

Business Card Directory

Call Marlene at 989-506-4647
for Advertising Information

Shop these local
Professionals



AT HOME ON CEDAR
Home Goods → Antiques
Collectables → Furniture
Vendor Resale Mall • Booths Available
Look for the Turquoise Building in the Middle of Gladwin
125 W. Cedar Ave., Gladwin MI 48624
989-426-9221

Stop Smoking NOW
Just \$199 Money Back Guarantee
Alma Hypnosis
(989)954-7210

KAPS ANA Member
located across from the Doherty Hotel
KOINS LLC
Silver & Gold Coins Bought & Sold
Integrity, Honesty & Peace of Mind.
That's what you deserve when it comes to your Coins & Currency!!!
Thomas Kapuscinski
611 N. McEwan St. Clare, MI 48617
231-357-2105 • 989-386-6500
tjkap@charter.net
Mon.-Fri. 9:30am-5:30pm
Sat. 10:00am-2:00pm
or by appointment
NOW BUYING Sterling Silverware & Scrap Gold
BBB ACCREDITED BUSINESS

Gateway Structures LLC
SPECIALIZING IN METAL CLAD STORAGE SHEDS
Multiple Colors & Custom Sizes Built to Order
FREE Delivery (within 70 miles)
7136 South Clare Ave. Clare, MI
Located 3 miles North of Clare
(voicemail) 989-418-9816

HENRY EXCAVATING & CONCRETE LLC
989-539-7542
CELL: 989-429-1175
POURED WALLS & ALL TYPES OF CONCRETE CONSTRUCTION
COMPLETE DOZER AND BACKHOE WORK
STUMPING • ROAD GRADING • FILL SAND
SEPTIC SYSTEMS • BLACK DIRT
GRAVEL • STONE • DITCHING
CRUSHED CONCRETE
CRUSHED ASPHALT
FULLY INSURED

MICHAEL HENRY TREE SERVICES LLC
989-539-7542
CELL: 989-339-4377
TREE REMOVAL & TRIMMING,
BRUSH CHIPPING AND CLEAN UP
STUMP GRINDING,
65' BUCKET TRUCK &
WOOD CHIPPER
INSURANCE WORK WELCOME -
STORM DAMAGE CLEAN UP
FULLY INSURED

SEVERING ALL OF MID MICHIGAN AREA!
FREE ESTIMATES - 3620 N. CLARE AVE. HARRISON, MI

FREE Hearing Test & Consult
bieri HEARING SPECIALISTS
888-641-0087
Clare and Midland Locations
www.bierihearing.com

TOM'S POLE BUILDINGS
Over 30 Years Experience
POLE BUILDINGS & GARAGES
ROOFING & SIDING
CONCRETE FLOORS DRIVEWAYS & FENCING
Special! FEATURING ULTRA 2000 19 colors to choose from
And A 45 YEAR WARRANTY
From Beginning permit To Cleanup, We Do It All!
1-800-541-3974
We accept major credit cards. • email: tomspolebuildings@yahoo.com

RAGLE'S REMODELING
★ Power Washing, Interior & External Painting, Drywall Installation & Repair, Ceramic Tile Installation & Repair, Kitchen & Bathroom Remodeling, Roofing, Windows, Doors & Floors, House Leveling, Metal Roof Specialist
40 Years Experience
HANDYMAN
2 YOUR RESCUE
989-533-1006
Free Estimates

BURKHART-PRESIDIO INSURANCE AGENCY
GLADWIN • 989.426.9278
Auto-Owners INSURANCE
LIFE • HOME • CAR • BUSINESS

COUNTRY SIDE VINYL WINDOWS
Wood is Good, Vinyl is Final!
Double Hung • Sliders • Basement • Casement
Several Different Grid Patterns & Colors Available
Vernon Troyer 1 3/4 miles North of Jays 7287 S. Clare Ave.
989-935-9117 Clare, MI 48617

E & K EXCAVATING
▪ SEPTIC SYSTEMS
▪ PONDS
▪ DRIVEWAYS AND ROADS
▪ LAND CLEARING
LICENSED
EDWIN STEINER
2239 EAST DENVER RD. ROSEBUSH, MI 48878
989-433-0004 or cell 989-430-2461

West Midland Family Center
4011 W. Isabella Bring this ad or mention it for a FREE GIFT!
Saturday, Doors open at 4:00
Early Birds Start at 6:00
Progressive Jackpot: \$5K
\$584.00
Proceeds go to fund the West Midland Family Center

SUPERIOR CONCRETE CONSTRUCTION
Professionally Placed Concrete
Residential • Commercial • Industrial • Agricultural
Laser Screed Insulated Poured Walls Waterproofing 36 Meter Concrete Boom Pump Excavating
Brick Textured Poured Walls Basements and Crawl Spaces Driveways and Sidewalks Floors and Footings Color Stamped Concrete Pole Barn Floors
Licensed Contractor Harrison, MI
Office 989-539-4390 • Cell 989-429-5045
kevinsuperiorconcrete@yahoo.com

ABC Auto Body
313 W. Knox Road, Beaverton, MI
1/2 Mile West of M-30
989-435-2707
We Take Pride In Your Ride!
• Quality Collision Repair • Custom Color Matching • Car/Light Truck
• Free Estimates • & Painting • Genuine Original
• Insurance Work • We Repair All Makes and Models • Equipment Parts
Welcome

PIONEER POLE BUILDINGS INC.
7400 S. Clare Ave. • Clare, Michigan 48617
800-292-0679
www.pioneerpole.com

ECOWATER SYSTEMS Lindsay Soft Water Co.
1209 Michigan Ave. St. Louis, MI 48880
(989) 681-5436 • 1-800-244-3464
P.O. Box 401 Gladwin, MI 48624
(989) 426-4220
Cell (989) 620-1263
www.ecowater.com
GABE EAREGOOD
Water Specialist

DEBRIS HAULING
Clean Out Basements Attics & Garages
Tear Downs Sheds & Garages
Scrap Metal
Commercial Buildings
25 Yards \$475
Free Estimates
DEBRIS HAULING
Good & Fast Quick & Quality Service
MOUNT PLEASANT AREA
No One Does It For Less, NO ONE!!!
Less than the price of a dumpster!
(989) 773-0735
Dan Syzak

POLE BARNS
James Morche Builders
YOUR BUILDER FROM START TO FINISH
garages • pole barns • concrete work
FREE estimates
James Morche Cell 989-429-3479 • 989-539-9126
Licensed & Insured

Tag's Auto Repair
2 yr. 25,000 mile warranty nationwide on parts & labor.
• COMPUTER DIAGNOSTIC SERVICE • 2 AND 4 WHEEL ALIGNMENT
BRAKES & FRONT END REPAIR!
• AC CHARGING
• TIRES AND BRAKES
• OIL CHANGES
FREE ROADSIDE ASSISTANCE PROGRAM TOWING, FLATS, LOCKOUTS, MORE!
CALL US FOR DETAILS!
3780 N. Clare Ave. Harrison
Hours M-F 8-5
989-539-1986

Our BEST SAVINGS during our 70th Anniversary!

Celebrate 70 Years of Sound with Miracle-Ear!



Why Miracle Ear? • 3 Year Warranty* • Lifetime of Aftercare • 30 Day Money Back Guarantee†

- **FREE HEARING EVALUATIONS AND FREE GIFTS!** Schedule an appointment for a **FREE hearing evaluation*** during this event and receive a \$20 Gift Card.**
- **SPECIAL ANNIVERSARY SAVINGS!** during this event only!
- **CONNECT** with your local, friendly staff, try out the latest technology, and ask as many questions as you would like!



Schedule a **FREE Hearing Evaluation*** during our Anniversary Event and receive a **\$20 GIFT CARD!****

BUY ONE, GET ONE

Special 70th Anniversary Savings

~~50% off~~ **70% OFF**

All Custom ME-1 Hearing Solutions • **HURRY! OFFER ENDS 9/30/2018**

Good only from participating Miracle-Ear® representatives. One coupon per purchase. No other offers or discounts apply. Discount does not apply to prior sales. Offer valid on ME-1 Custom Solutions Only. Cannot combine with any other offers.

BATTERIES

STOP IN DURING OUR ANNIVERSARY CELEBRATION AND RECEIVE **3 FREE PACKS OF BATTERIES**



Good for all Makes & Models! 4 Per Pack. Limit 3 Packs/Household. Not valid with any other offer. **OFFER ENDS 9/30/2018!**



Appointments and supplies of **FREE Gift Cards and Batteries** Limited for this Special Event!

(866) 981-3022

Mt. Pleasant
100 S. Mission, Suite G
South of Rite Aid

Clare
1430 N. McEwan
In the Carousel Mall

Midland
6841 Eastman Ave
Behind Olive Garden

Alma
116 W. Superior, Suite 7
Heritage Towne Square

Gladwin
127 N. Arcade, Suite 2
In the Neely Building

Prudenville
828 W. Houghton Lake Dr.
Corner of M55 & M18

PLUS 14 MORE LOCATIONS IN MICHIGAN! ...AND OVER 1,300 NATIONWIDE!

CALL NOW to receive our best savings during our 70th Anniversary Celebration!

Are you like the more than 38 million Americans struggling to hear clearly? **NOW** is the time to **Schedule an Appointment** for a **FREE** hearing evaluation.* **HERE TO STAY!** We've been around 70 years and will be around for many years to come to provide the invisible styles and advanced features you want and need!



JUST ASK! We accept most insurances!

NO INSURANCE? Financing plans are available to fit nearly any budget! With qualified credit, payments as low as \$22/month!

*Our hearing test and video otoscopic inspection are always free. Hearing test is an audiometric test to determine proper amplification needs only. These are not medical exams or diagnoses nor are they intended to replace a physician's care. †If you are not completely satisfied, the aids may be returned for a full refund within 30 days of the completion of fitting, in satisfactory condition. **Offer is valid at participating Miracle-Ear locations. Must be at least 55 years of age and complete a hearing test and a product demonstration to receive gift card. New customers only. One per household.

12 MONTHS NO INTEREST FINANCING MINIMUM \$300 PURCHASE, WITH APPROVED CREDIT



KUBIN'S
40th
Anniversary

MATTRESS SALE!
A MATTRESS FOR EVERY BUDGET!



Super DEAL
Serta
Twin Mattress
\$99

Dare to Compare
\$699
Queen Mattress,
Your Choice
Firm, Plush,
Super Pillowtop



Not just sorta comfortable.
Serta comfortable.™



The only official mattress of the National Sleep Foundation.

Serta Firm	Westmark Your Choice Plush or Firm	Signature Suite 2-Sided Flipable Mattress	IComfort																																													
\$299 was \$449 Queen Mattress	\$499 was \$749 Queen Mattress	\$799 was \$1199 Queen Mattress	\$1099 was \$1649 Queen Mattress																																													
<table border="0"> <tr> <td></td> <td>COMPARE AT</td> <td>NOW!</td> </tr> <tr> <td>Twin Mattress</td> <td>\$329</td> <td>\$219</td> </tr> <tr> <td>Full Mattress</td> <td>\$439</td> <td>\$289</td> </tr> </table>		COMPARE AT	NOW!	Twin Mattress	\$329	\$219	Full Mattress	\$439	\$289	<table border="0"> <tr> <td></td> <td>COMPARE AT</td> <td>NOW!</td> </tr> <tr> <td>Twin Mattress</td> <td>\$589</td> <td>\$389</td> </tr> <tr> <td>Full Mattress</td> <td>\$699</td> <td>\$459</td> </tr> <tr> <td>King Mattress</td> <td>\$1129</td> <td>\$749</td> </tr> </table>		COMPARE AT	NOW!	Twin Mattress	\$589	\$389	Full Mattress	\$699	\$459	King Mattress	\$1129	\$749	<table border="0"> <tr> <td></td> <td>COMPARE AT</td> <td>NOW!</td> </tr> <tr> <td>Twin Mattress</td> <td>\$899</td> <td>\$599</td> </tr> <tr> <td>Full Mattress</td> <td>\$1079</td> <td>\$719</td> </tr> <tr> <td>King Mattress</td> <td>\$1479</td> <td>\$979</td> </tr> </table>		COMPARE AT	NOW!	Twin Mattress	\$899	\$599	Full Mattress	\$1079	\$719	King Mattress	\$1479	\$979	<table border="0"> <tr> <td></td> <td>COMPARE AT</td> <td>NOW!</td> </tr> <tr> <td>Twin Mattress</td> <td>\$989</td> <td>\$659</td> </tr> <tr> <td>Full Mattress</td> <td>\$1379</td> <td>\$919</td> </tr> <tr> <td>King Mattress</td> <td>\$2399</td> <td>\$1599</td> </tr> </table>		COMPARE AT	NOW!	Twin Mattress	\$989	\$659	Full Mattress	\$1379	\$919	King Mattress	\$2399	\$1599
	COMPARE AT	NOW!																																														
Twin Mattress	\$329	\$219																																														
Full Mattress	\$439	\$289																																														
	COMPARE AT	NOW!																																														
Twin Mattress	\$589	\$389																																														
Full Mattress	\$699	\$459																																														
King Mattress	\$1129	\$749																																														
	COMPARE AT	NOW!																																														
Twin Mattress	\$899	\$599																																														
Full Mattress	\$1079	\$719																																														
King Mattress	\$1479	\$979																																														
	COMPARE AT	NOW!																																														
Twin Mattress	\$989	\$659																																														
Full Mattress	\$1379	\$919																																														
King Mattress	\$2399	\$1599																																														

MATTRESS DOORBUSTERS ★ SAVE UP TO \$500 ★



Featuring TempActiv™ Max Gel Memory Foam
In select models, see store for details.



Featuring TempActiv™ Gel Memory Foam with an Advanced Coil Support System



FREE! FREE! FREE!

DELIVERY*
With Mattress or Set Purchase of \$699 or more

Set Up*
With Mattress or Set Purchase of \$699 or more

Removal
of Old Mattress or Set purchase of \$699 or more



Kubin's Furniture & Mattresses
101 N Mill St, Corner of M46, St. Louis, Michigan, (989) 681-5043
Hours: Mon-Thurs: 9-6, Fri: 9-8, Sat: 9-5, Closed Sunday
Shop On Line! www.kubins.com



*SEE STORE FOR DETAILS

*NOT RESPONSIBLE FOR TYPOGRAPHICAL AND PRICING ERRORS. PHOTOS FOR ILLUSTRATION ONLY. SEE STORE FOR DETAILS.



Northwoods Wholesale Outlet

Find us on 

SHOP 24 HOURS AT WWW.NORTHWOODSOUTLET.COM

(989) 879-1110

Exit 181, then 2.5 miles east to the light. Then 2 blocks east of the light off M-13 in Pinconning.

Keebler
Fudge Stripes
Fudge-O-Saurus
Dino Edition
11.5 oz.



Keebler
Chips Deluxe
Rainbow Cookies
with M&M's
11.3 oz.



Keebler
Vienna Fingers
Crème Filled
Sandwich Cookies
14.2 oz.



Keebler
Chips Deluxe
Chocolate Chunk
Cookies
11.6 oz.



Keebler
Town House
Original Crackers
13.8 oz.



Keebler
Club Original Cracker
13.7 oz.



FINALLY BACK!!

STARTING SEPT. 29TH!

Keebler Cookies & Crackers
At Retailers You've "NEVER" Seen!

STARTING SEPT. 29TH!

Prices So Low We Can't Advertise The Retailers!

Cheez-it
Grooves Sharp White Cheddar or
Loaded Cheesy Taco
9 oz. box



REG. \$3.49
SAVE \$2.24
4/\$5.00

Reese's or Reese's
Pieces Snack Size
Peanut Butter Cups
10.5 oz. bag



REG. \$3.99
SAVE \$2.32
3/\$5.00
Your Choice!

Gourmet
Hershey's Kettle Corn Popcorn
16 oz. bag



REG. \$11.99
SAVE \$10.32
3/\$5.00

Twizzlers
Strawberry Twists or
Mixed Berry Pull & Peel



- Sour Rainbow Bites
- Nibs Super Long Cherry
- Chocolate Twist
- Twist Sour Mini
- Cherry Bites
- Key Lime Pie

12 oz. - 16 oz. bag

REG. \$2.99
SAVE \$1.99
\$1.00

Hershey's
Cookies 'N' Creme or S'mores
Chocolate Chips
7 oz. - 9 oz. bags



REG. \$2.59
SAVE \$1.59
\$1.00

229 W 5TH ST., PINCONNING, MI 48650 • NO RAIN CHECKS • WHILE SUPPLIES LAST
OPEN 6AM TO 10PM 362 DAYS A YEAR! NOT RESPONSIBLE FOR PRINTING ERRORS

1-989-879-1110 • NORTHWOODSOUTLET.COM
SALE ENDS October 10, 2018

Park it in the CLASSIFIEDS



and watch it go fast!

GARAGE SALES

YARD, RUMMAGE & GARAGE SALES

1 DAY Estate Sale . Sept 28, 8am-4pm. Isabella Village, 5242 E Broadway, lot 385. Mt Pleasant

BIG GARAGE sale, Sat. Sept 22, 8:30-5:30 corner of Charles & Fairlane, Alma.

ESTATE SALE 5340 Blue Heron Dr, Alma Sept 27-29, 9-4. 1952 Ford truck, house furniture, complete household must go!

GARAGE SALE, Sept 28th & 29th, 8-6, 976 N Lincoln Rd., Mt Pleasant. Bed mattress, exercise bike, jewelry & lots more.

HUGE POLE Barn Sale, furniture, doors & windows, hearth & fireplace, dodge motor + parts, 2 quads, to much to list! 4403 W Coleman Rd, Lake. Sept 20-22, 8:30-5:30

SALE. EVERYTHING MUST GO! To Much To List. Sept 28-29 9am-? 9532 E Blanchard Rd, Shepherd

HELP WANTED GENERAL

Morning Sun including Mid Michigan Buyers Guide Route Available in Mt Pleasant/Oil City Area

7 days a week, between the hours of 2am-8am. Experienced carrier with reliable vehicle. Please call 989-779-6156 and leave name & phone number.

Trelan Manufacturing is taking applications for **QUALIFIED WELDERS, MACHINISTS, PARTS DEPARTMENT EMPLOYEES, SERVICE TECHNICIANS, AND INTERNET/MARKETING SPECIALISTS.**

Excellent Pay and Benefits. Apply Monday thru Friday 9:00 a.m. - 3:00 p.m. at 498 Eight Mile Rd. Remus, MI 49340 or print an application on line from www.trelan.com and mail it to Trelan Manufacturing.

HELP WANTED PART TIME

CLEANING POSITION in Ithaca, M-F, evenings Please call 989-331-4319.

FURNITURE

AN AMISH Log Headboard and Queen Pillow Top Mattress Set. Brand new-never used, sell all for \$275. Call anytime 989-832-2401.

LAWN & GARDEN

WILLIAMS LAWN CARE. (989) 239-0810 **MOWING, TREE TRIMMING, LANDSCAPING.**

MISCELLANEOUS

6 INCH stainless steel stove pipe, 308. 3 ft \$20. & 4 ft \$25 lengths Call (989) 644-5206

A PLACE FOR MOM has helped over a million families find senior living. Our trusted, local advisors help find solutions to your unique needs at NO COST TO YOU. 866-760-7235.

ADJUSTABLE BED Brand New with Imcomfort gel memory foam mattress. Retail Cost \$5,900.00, sacrifice for \$997.00. Call for showing or delivery: 989-615-2951.

Call **Empire Today** to schedule a FREE in-home estimate on Carpeting & Flooring. Call Today! 1-855-404-3569

MISCELLANEOUS

▲ CASH FOR GOLD

▲ CASH FOR GUNS

GLADWIN TRADE & SALES
1739 N. STATE ST. GLADWIN (North M-18)
989-426-6811

GENERAL ANNOUNCEMENTS

TO ALL MID-MICHIGAN BUYER'S GUIDE CUSTOMERS

Deadline for Mid-Michigan Buyer's Guide classifieds is Wednesday before 5pm
If you need assistance placing classifieds, please call Cindy at 989-779-6115

MISCELLANEOUS

ADJUSTABLE BED Brand New with Imcomfort gel memory foam mattress. Retail Cost \$5,900.00, sacrifice for \$997.00. Call for showing or delivery: 989-615-2951.

AMISH BUILT mini cabins or storage sheds delivered to your site anywhere in Michigan! Starting under \$1,000.00 mynextbarn.com 989-832-1866

Amish Log Beds, Dressers, Rustic Table and Chairs, Mattresses for Cabin or Home. Lowest price in Michigan! dandanthemattressman.com 989-923-1278

BATHROOM RENOVATIONS. EASY, ONE DAY updates! We specialize in safe bathing. Grab bars, no slip flooring & seated showers. Call for a free in-home consultation: 844-649-6840

BUILT BEST BARN Michigan's Largest Pole Barn Company. Best Quality, Best Service, SUMMER SALE GOING ON NOW! Call for Special pricing!
24'x24'x8'
24'x32'x8'
24'x40'x10'
30'x40'x10'
30'x40'x12'
32'x48'x12'

Completely Built, (Concrete Floor Optional) License/Insured 1-877-802-9591 (Office) 989-205-2534 (Cell)

BUILT RITE POLE BUILDINGS, Michigan's finest! 24X40X10 \$10,800.00, 30X40X10 \$13,300.00. Erected on your site state-wide! Call for price on any size building 877-296-6802 or go to www.BuiltRitePoleBuildings.net

CASH FOR CARS: We Buy Any Condition Vehicle, 2002 and Newer. Competitive Offer! Nationwide FREE Pick Up! Call Now For a Free Quote! 888-366-5659

DIRECTV SELECT PACKAGE! Over 150 Channels, ONLY \$35/month (for 12 mos.) Order Now! Get a \$100 AT&T Visa Rewards Gift Card (some restrictions apply) CALL 1-888-351-0154

DISH Network. 190+ Channels. FREE Install. FREE Hopper HD-DVR. \$49.99/month (24 months) Add High Speed Internet-\$14.95 (where avail.) CALL Today & SAVE 25%! 1-866-950-6757

DONATE YOUR CAR TO CHARITY. Receive maximum value of write off for your taxes. Running or not! All conditions accepted. Free pickup. Call for details. 855-413-9672

Earthlink High Speed Internet. As Low As \$14.95/month (for the first 3 months.) Reliable High Speed Fiber Optic Technology. Stream Videos, Music and More! Call Earthlink Today 1-844-275-3510

FOR SALE Machine lathe. 36 inch bed, 10 inch swing. \$400. Call (989) 644-5206

Live Estate Auction, Saturday, October 6, 2018, 10:30 AM. 9800 Maplewood Drive, Clio, MI. Three Bedroom home, 2015 Chevy Cruze, JD rider, furniture, appliances, tools. Details and photos at www.TimsAuctionService.com 989-912-8701

MEET SINGLES RIGHT NOW! No paid operators, just real people like you. Browse greetings, exchange messages and connect live. Try it free. Call now: 855-247-5909

PIONEER POLE BUILDINGS Free Estimates Licensed and Insured. 2x6 Trusses. 45 Year Warranty Galvalume Steel-19 Colors. Since 1976 #1 in Michigan Call Today 1-800-292-0679

RACING GREAT JackConely Estate Auction Sept. 29, 10am. 11023 Hi Tech Dr., Whitmore Lake, MI 48189. Race Cars, Projects, Speed Shop, Performance Parts. NarhiAuctions.com 810.266.6474.

Reach Across Michigan with a MegaMarket Statewide Classified Ad! Over 1.2 million weekly circulation just \$249 per week! Buy 3 - Get 1 Free! Call 800.783.0267

SPECTRUM TRIPLE Play! TV, Internet & Voice for \$29.99 ea. 60MB per second speed No contract or commitment. More channels. Faster Internet. Unlimited Voice. Call 1-866-729-0394

VIAGRA & Cialis Alternative, 60 pills for \$99. 100 pills for \$150 FREE shipping. Money back guaranteed! Save Now! Call today 1-800-610-4820

GENERAL ANNOUNCEMENTS

MISCELLANEOUS

Start Saving BIG On Medications! Up to 90% Savings from 90DAYMEDS! Over 3500 Medications Available! Prescriptions Req'd. Pharmacy Checker Approved. Call Today for Your FREE Quote. 855-398-4002

Stay in your home longer with an American Standard Walk-In Bath. Receive up to \$1,500 off, including a free toilet, and a lifetime warranty on the tub and installation! Call us at 1-855-271-8452

BUILDING MATERIALS & SUPPLIES

BUILT BEST BARN Michigan's Largest Pole Barn Company. Best Quality, Best Service, SUMMER SALE GOING ON NOW! Call for Special Pricing!
24'x24'x8'
24'x32'x8'
24'x40'x10'
30'x40'x10'
30'x40'x12'
32'x48'x12'

Completely Built, (Concrete Floor Optional) License/Insured 1-877-802-9591 (Office) 989-205-2534 (Cell)

PIONEER POLE BUILDINGS Free Estimates Licensed and Insured. 2x6 Trusses. 45 Year Warranty Galvalume Steel-19 Colors. Since 1976 #1 in Michigan Call Today 1-800-292-0679

DOGS

3 AUSTRALIAN Shepherd pups, 6 ACA registered Norwegian Elk Hound pups, 8wks old, for more information call (989)386-3679, CLARE, MI

CHOCOLATE LAB PUPS, PARENTS AKC & OFA CERTIFIED. NOW TAKING DEPOSITS \$200., G \$850/B \$750 CALL/TEXT BEVERLY 989-802 2360

ENGLISH BULLDOG PUPPIES, Gorgeous! AKC reg., male & female. Ready October 28th. Now Taking Deposits. 810-569-2625

ENGLISH MASTIFF PUPPIES. (989)424-1958

FARM FEED & SUPPLIES

3RD PRIME CUT ALFALFA, (Call for price); Straw, \$4/Bale; Cracked Corn \$12/100; Shelled-Corn, \$10/100; Cob-Corn, \$5/Bag; Rye, Barley, Wheat, Oats \$12/bag. Delivery-Available. (989)433-5418 Cell# (989)965-1391

APARTMENTS FOR RENT (UNFURNISHED)

DUPLEX APARTMENT for Rent, 2 bed, 1.5 ba., basement w/ washer & dryer, \$725/mo, no pets. Mt Pleasant 989-854-1814

HOUSES FOR RENT (UNFURNISHED)

3 bd country home with appliances. \$700./mo 989-875-3082

COMMERCIAL RENTALS

RETAIL/OFFICE, 888 S. Mission, next to Taco Boy. 1,100 to 2,200 sq. ft. Great parking & heavy traffic. (989) 817-4411

EITHER BUYING, selling, or trading, a classified is a good investment.

ESTATE SALES

SHEFFERT QUALITY SALE
3114 HILL TOP DR.
MINERAL SPRINGS SUBDIVISION

THURSDAY SEPT. 27TH 9-5:00
FRIDAY SEPT. 28TH 9-4:00

DIRECTIONS: From Mt.Pleasant travel West on M-20 to the corner M-20 & Winn Rd. Turn Left (South) proceed 1 1/2 miles to Hill Top Dr. Turn Right (West) Second House on Your Right, Follow signs to Sale!

Note: This beautiful 6000 sq. ft. home contains quality furniture, décor & household all in spotless condition! Don't miss this sale!

BEAUTIFUL CURVED BROWN LEATHER SECTIONAL/OTTOMAN; CHERRY TABLE/6 CHAIRS & 2 LEAVES; 8 FT. ETHAN ALLEN CHERRY/BURLED WOOD CABINET WITH SLIDING GLASS DOORS; STANDLEY CHERRY DRESSER/MIRROR, CHEST, (2) NIGHT STANDS, SOFA TABLE; (2)QUEEN MATTRESS SETS; RUST LOVESEAT; SMITH BROS. CHAIR/OTTOMAN; GREEN RECLINER; CONTEMPORARY FABRIC RECLINER; COUNTRY FRENCH WHITE SIDE TABLE; COUNTRY FRENCH PLAID CHAIR/OTTOMAN; LINENS; BOOKCASE/HUTCH; BLACK SHELF/STAND; BLACK END TABLE & SOFA TABLE; CHERRY DESK & FILE CABINET; LEATHER DESK CHAIR; STANDLEY CHERRY CABINET; BLACK DESK;(2) LG. BLUE POTTERY VASES; MIRRORS; 8X10 WOOL AREA RUG; PINE CUPBOARD; TAN CONTEMPORARY CHAIR; DINING CHAIRS(4); LG TV; SAMSUNG TV; PHILIPS DVD PLAYER; ART WORK; LAMPS; DÉCOR; WOODEN ROCKER; CHILDS TABLE/2 CHAIRS; OAK STORAGE UNIT (2); TOYS; CHILDS JOHN DEERE PEDAL TRACTOR & ELECTRIC GATOR W/DUMP BOX; GRAY HALL TABLE; FOOSBALL & SPORTCRAFT HOCKEY TABLES; XBOX 360 & GAMES; STICKLEY CHERRY CABINET;PUSH LAWN MOWER; SMALL UPRIGHT FREEZER; WINE REFRIGERATOR; ASST. HAND & POWER TOOLS; BIKES; SPORTING EQUIPMENT; 18 FT. TRAMPOLINE; DVDS; BOOKS MUCH MORE! CASH

Note: This is a pre-priced House Sale
OPEN 9:00 AM SHARP CASH
CENTRAL ESTATE SALE SERVICE
PATTY & MIKE GOSTOLA 989-772-2053

MISCELLANEOUS

Attention all homeowners in jeopardy of Foreclosure? We can help stop foreclosure. We can help you with Loans Modifications. Foreclosure Defense Helpline. Call is absolutely free. 1-800-582-5804

PASSENGER CARS

2013 FORD TAURUS SLE

One owner, Local trade, only 36,000 miles, Heated Leather, navigation, 100% flawless inside and out! Must SEE!!

ONLY \$14,995 or about \$239/mo.

Dick Sovo Auto Sales (989) 828-6032 dicksovaautosales.com

2014 GMC TERRAIN

One owner, Local trade, only 37,000 miles, 100% spotless!

ONLY \$15,995 or about \$249/mo.

Dick Sovo Auto Sales (989) 828-6032 dicksovaautosales.com

2015 JEEP GRAND CHEROKEE 4X4 LIMITED

One owner, heated leather, navigation, power lift gate, 20" wheels, Summit White, neutral leather, absolutely beautiful.

ONLY \$28,995 or about \$419/mo.

Dick Sovo Auto Sales (989) 828-6032 dicksovaautosales.com

2017 GMC Crew Cab 4x4

Only 15,000 miles! Navigation, double power seats, both sides. Z71 Package. Absolutely beautiful truck! Save Thousands!

ONLY \$36,995 or about \$529/mo.

Dick Sovo Auto Sales (989) 828-6032 dicksovaautosales.com

PARTS & SERVICE

#1 IN brakes & front end service. Same day service, fast in & out, best prices. Discount Tire St. Louis. 989-681-4100

BATTERIES, BATTERIES, BATTERIES! We stock them all. Prices start at \$59.95. Nobody sells for less! Discount Tire, St. Louis. 989-681-4100

TIRE SPECIALS EVERY DAY We will not be undersold. Discount Tire & Battery still Central Mich. #1 Tire Supplier. There must be a reason to call. 989-681-4100 St. Louis

A SPLASH OF COLOR GETS RESULTS

Color Classified Ads Now Available!!!

ESTATE SALES

NEED HELP? CALL A LOCAL PROFESSIONAL FROM OUR

Professional Services Directory

HEALTH & FITNESS

OXYGEN - Anytime. Anywhere. No tanks to refill. No deliveries. The All-New Inogen One G4 is only 2.8 pounds! FAA approved! FREE info kit: 855-970-1066

VIAGRA AND CIALIS USERS! 100 Generic Pills SPECIAL \$99.00 FREE Shipping! 100% guaranteed. 24/7 CALL NOW! 888-835-7273 Hablamos Espanol

LANDSCAPE & TREE MAINTENANCE

ARBOR TREE SERVICE. Storm Damage, Landscaping, Tree Trimming & Removing. 20 Years Experience. Call 989-763-3830

PAWN SHOP
Buy, Sell, Pawn

3 Month Pawn
3% + 1.00 Storage
Firearms, Gold & More

Gladwin Trade & Sales
989-426-6811

Don't Wreck Your Life!

KEEPING HEALTHY IS UP TO You!

Do you have a car for sale? Or maybe some furniture?

How about a boat?

Call to place a classified ad with one of our helpful representatives & sell your no longer wanted items FAST!



Long's Hearing EXTENDED OPEN HOUSE Event

**SAVE UP TO
60% OFF
MSRP PLUS FREE
AUDIOMETRIC
TESTING!**

**CALL TODAY
for an
appointment**

Welcome to the
hearing revolution



Built on our most powerful and efficient platform — the Thrive platform, Livio AI is the world's first hearing aid to provide both superior sound quality and the ability for patients to track their brain and body health. As the first-ever hearing aid to feature integrated sensors and artificial intelligence, Livio AI is a multi-purpose device that redefines what a hearing aid can do.

Comfort and personalization redefined

It's been proven that hearing health is directly connected to overall health and well-being.

When you're able to hear and engage with the world around you, you live a better and healthier life.

Cognitive Decline

Adults with untreated hearing loss experience a **30-40% faster decline** in cognitive abilities compared to peers with aided hearing.



Dementia

Adults with untreated loss are more likely to develop dementia.

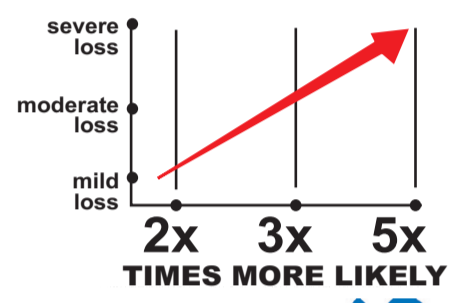

Depression

Those with untreated hearing loss have **significantly higher** incidence of feelings of isolation and depression.



Balance



People with **mild hearing loss (25 dB)** are more likely to have a history of falling. Every additional 10 decibels of hearing loss increases the chances of falling by **1.4 times** the original risk.

Lifespan

Studies show older **adults with untreated impaired hearing** have a **shorter lifespan** than peers.



Tinnitus

90% of people with tinnitus have hearing loss.

0% Interest! JUST 1/2 DOWN and LOW Monthly Payments WITH NO INTEREST!

- Mike Long, owner of Long's Hearing Care Systems, attends training in Minnesota regularly to keep abreast of the latest techniques and technology in hearing aids.
- Your satisfaction grows our business. We offer a 100% money-back guarantee.
- We pride ourselves in offering products and services that are tailored to fit your specific needs and lifestyle.
- Outdoorsmen, musicians, and those who work in environments with extreme background noise all have different concerns that we can help address with our expertise and high-tech products.
- We pledge to always do what's right for you. Our honest business philosophy has been trusted by generations of families for over 30 years.
- We won't inflate prices to offer unbelievable discounts, buy-one-get-one-free offers, or other schemes.

"People don't care how much you know until they know how much you care!"
~ Mike Long

Call us today to experience friendly, knowledgeable, professional service and quality hearing aids at affordable prices! Serving the Community for Over 30 Years!

Long's Hearing Care Systems

www.longshearing.com

CADILLAC LOCATION • CALL TOLL FREE 1-800-286-1378

1027 N. Mitchell St. • 231-779-0400

HOUGHTON LAKE • 6868 W. Houghton Lake Drive

CALL TOLL FREE 1-800-286-1378

TRAVERSE CITY • 4000 Eastern Sky Drive

CALL TOLL FREE 1-800-286-1378

(Off Silver Lake Road and Copper Ridge)

Rudyard Michigan Upper Peninsula Community Center

Satisfaction Guaranteed



We accept most insurance plans. Payment plans also available

30 YEARS TRUST!

Gladwin City Housing Commission

Low Income Housing

989-426-5721



**NO
SMOKING
FREE HEAT
AND RENT BASED
ON INCOME**



If you or a family member are in need of new place to live, the Gladwin City Housing Commission has 2 or 3 bedroom duplexes or single bedroom apartments. All properties are smoke-free, clean, affordable and located in downtown Gladwin and Beaverton. Rent is 30% of your income and includes appliances and utilities or a utility allowance. Pets are welcome.

The apartment buildings have many benefits such as on-site laundry, several lounges and a dining center with lunch service provided by Council on Aging.

Duplexes provide a great environment for your family. There is plenty of living space and a yard.

You do not have to live in Gladwin or Beaverton to apply. Contact the Gladwin City Housing Commission at 989-426-5721 to see if you qualify. An Equal Housing Opportunity.